

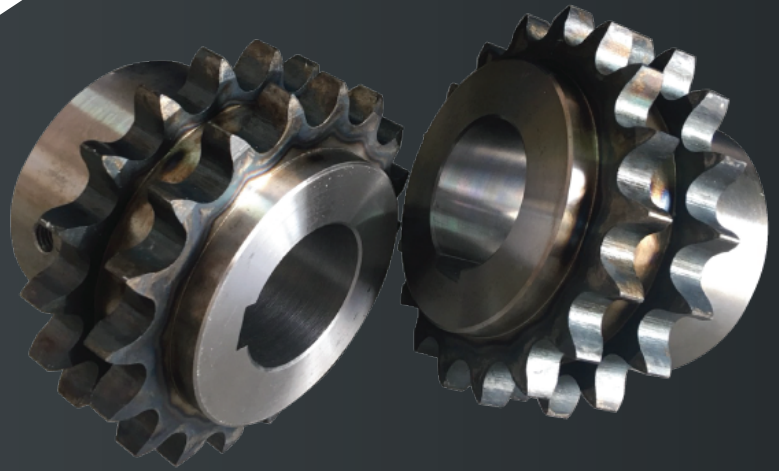

บริษัท ไทยซันเฮอ คอนเวเยอร์ จำกัด  
THAI SAN HER CONVEYOR CO.,LTD.



# SPROCKET

## 鏈齒輪

**THAI SAN HER CONVEYOR CO.,LTD.**

Machinery Parts Manufacturer  
ผู้ผลิตอะไหล่เครื่องจักรอุตสาหกรรม



[tshconveyor@hotmail.com](mailto:tshconveyor@hotmail.com)



02-036-0997-8,  
02-036-0896



[www.tshconveyor.com](http://www.tshconveyor.com)



# SPROCKET

ผลิตเฟืองโซ่ทุกขนาด



## STEEL & STAINLESS DOUBLE PITCH SPROCKET

TYPE:

03B, 05B, 06B, 08B, 10B, 12B, 16B, 20B, 24B, 28B, 32B (1R-2R-3R)

RS 25, RS 35, RS 40, RS 50, RS 60, RS 80, RS 100,

RS 120, RS 140, RS 160, RS 180, RS 200, RS 240 (1R-2R-3R)

RF 2040S, R, RF 2050S, R, RF 2060S, R, R2080S, R

RF 20100S,R, RF 2122R, RF 2162R



## Chain Sprocket Types

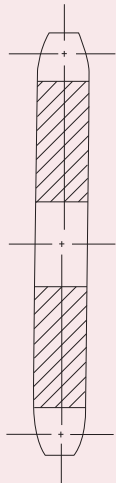

**TYPE A**

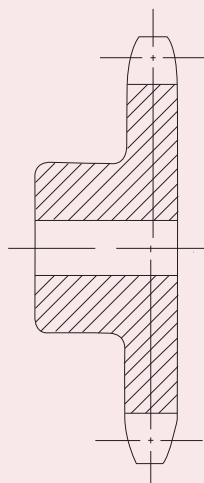

**TYPE B**

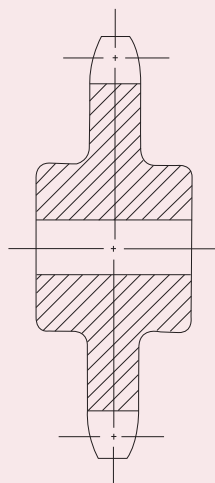

**TYPE C**

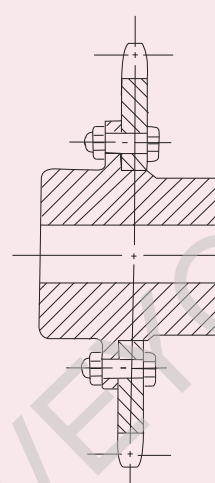

**TYPE D**

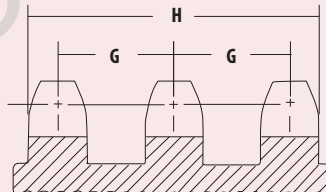
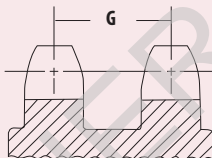
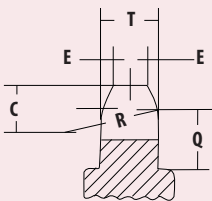

墜鏈編號 No.	節距 Pitch	滾子徑 Dia.	C	E	R	O	G	H	T	
									單列 1R	雙列 2R
RS 40	12.70	7.94	6.35	1.59	13.49	7.0	14.29	35.58	7.2	7.0
RS 50	15.88	10.16	7.94	1.99	16.87	10.3	17.92	44.23	8.7	8.4
RS 60	19.05	11.90	9.53	2.38	20.22	11.8	22.78	56.86	11.7	11.3
RS 80	25.40	15.87	12.70	3.18	26.98	15.5	29.26	72.72	14.6	14.2
RS 100	31.75	19.05	15.88	3.97	33.71	19.2	35.78	88.56	17.6	17.0
RS 120	38.10	22.23	19.05	4.76	40.46	23.0	45.45	113.6	23.5	22.7
RS140	44.45	25.40	22.23	5.56	47.19	27.0	48.75	120.2	23.5	22.7
RS 160	50.80	28.58	25.40	6.35	53.95	31.6	58.42	145.24	29.4	28.4
RS 200	63.50	39.69	31.75	7.94	67.41	38.7	70.56	175.22	35.3	34.1

## Sprocket #RS25 (1/4" Pitch) 尺寸表

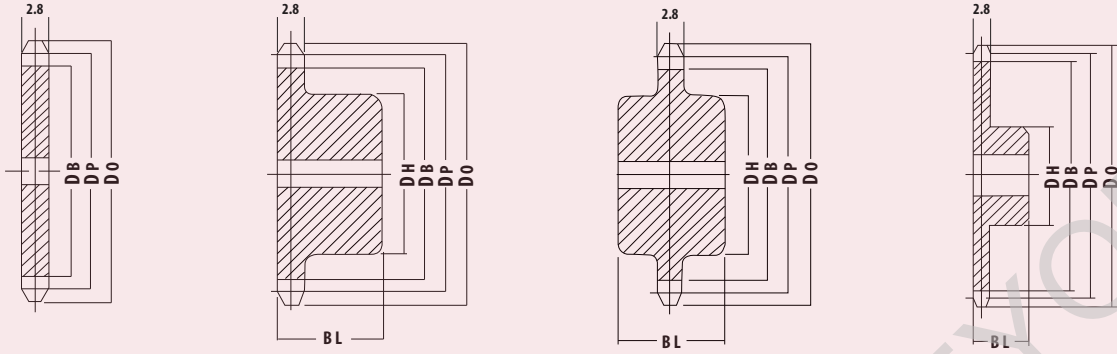

齒數 T	外徑 DO	節距徑 DP	齒底徑 DB	齒底徑 DC	輪設		材質 MAT'	齒數 T	外徑 DO	節距徑 DP	齒底徑 DB	齒底徑 DC	輪設		材質 MAT'
					徑 DH	長 BL							徑 DH	長 BL	
10	24	20.55	17.25	17.25	14	15	STEEL / S45C / SUS / MC NYLON	50	105	101.13	97.83	97.83	50	20	STEEL / S45C / SUS / MC NYLON
11	25	22.54	19.24	19.01	15	15		51	107	103.15	99.85	99.80	50	20	
12	28	24.53	21.23	21.23	15	15		52	109	105.17	101.87	101.87	50	20	
13	30	26.53	23.23	23.04	20	15		53	111	107.19	103.89	103.84	50	20	
14	32	28.54	25.24	25.24	20	15		54	113	109.21	105.91	105.91	50	20	
15	34	30.54	27.24	27.07	20	15		55	115	111.23	107.93	107.88	50	20	
16	36	32.55	29.25	29.25	25	15		56	117	113.25	109.95	109.95	50	20	
17	38	34.56	31.26	31.11	25	15		57	119	115.27	111.97	111.93	50	20	
18	40	36.57	33.27	33.27	25	15		58	121	117.29	113.99	113.99	50	20	
19	42	38.58	35.28	35.15	28	15		59	123	119.31	116.01	115.97	50	20	
20	44	40.59	37.29	37.29	28	15		60	125	121.33	118.03	118.03	50	20	
21	46	42.61	39.31	39.19	28	15		61	127	123.35	120.05	120.01	50	20	
22	48	44.62	41.32	41.32	30	15		62	129	125.37	122.07	122.07	50	20	
23	50	46.63	43.33	43.23	30	15		63	131	127.39	124.09	124.05	50	20	
24	52	48.65	45.35	45.35	30	15		64	133	129.41	126.11	126.11	50	20	
25	54	50.66	47.36	47.27	35	15		65	135	131.43	128.13	128.10	50	30	
26	56	52.68	49.38	49.38	35	15		66	137	133.45	130.15	130.15	50	30	
27	58	54.70	51.40	51.30	35	15		67	139	135.47	132.17	132.14	50	30	
28	60	56.71	53.41	53.41	35	15		68	141	137.50	134.20	134.20	50	30	
29	62	58.73	55.43	55.35	35	15		69	143	139.52	136.22	136.18	50	30	
30	64	60.75	57.45	57.45	35	15		70	145	141.54	138.24	138.24	50	30	
31	66	62.77	59.47	59.39	40	20		71	147	143.56	140.26	140.22	50	30	
32	68	64.78	61.48	61.48	40	20		72	149	145.58	142.28	142.28	50	30	
33	70	66.80	63.50	63.43	40	20		73	151	147.60	144.30	144.26	50	30	
34	72	68.82	65.52	65.52	40	20		74	153	149.62	146.32	146.32	50	30	
35	74	70.84	67.54	67.47	40	20		75	155	151.64	148.34	148.31	50	30	
36	76	72.86	69.56	69.56	40	20		76	157	153.66	150.36	150.36	50	30	
37	78	74.88	71.58	71.51	40	20		77	159	155.68	152.38	152.35	50	30	
38	80	76.90	73.60	73.60	40	20		78	161	157.70	154.40	154.40	50	30	
39	82	78.91	75.61	75.55	40	20		79	163	159.72	156.42	156.39	50	30	
40	84	80.93	77.63	77.63	40	20		80	165	161.74	158.44	158.44	50	30	
41	87	82.95	79.65	79.59	50	20		81	167	163.76	160.46	160.43	50	30	
42	89	84.97	81.67	81.67	50	20		82	169	165.78	162.48	162.48	50	30	
43	91	86.99	83.69	83.63	50	20		83	171	167.81	164.51	164.48	50	30	
44	93	89.01	85.71	85.71	50	20		84	174	169.83	166.53	166.53	50	30	
45	95	91.03	87.73	87.68	50	20		85	176	171.85	168.55	168.52	50	30	
46	97	93.05	89.75	89.75	50	20		86	178	173.87	170.57	170.57	50	30	
47	99	95.07	91.77	91.72	50	20		87	180	175.89	172.59	172.56	50	30	
48	101	97.09	93.79	93.79	50	20		88	182	177.91	174.61	174.61	50	30	
49	103	99.11	95.81	95.76	50	20		90	186	181.95	178.65	178.65	50	30	

**Sprocket #RS35 (3/8" Pitch) 尺寸表**

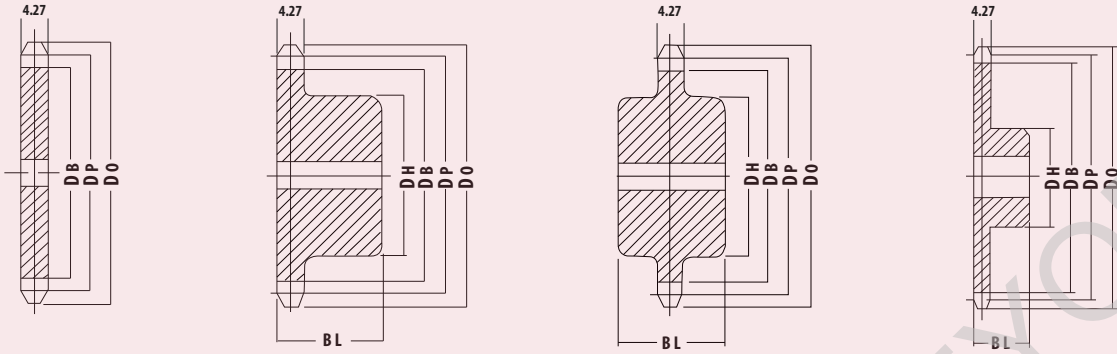

齒數 T	外徑 DO	節距徑 DP	齒底徑 DB	齒底徑 DC	輪殼		材質 MAT'	齒數 T	外徑 DO	節距徑 DP	齒底徑 DB	齒底徑 DC	輪殼		材質 MAT'
					徑 DH	長 BL							徑 DH	長 BL	
10	35	30.84	25.78	25.78	20	20	STEEL / S45C / SUS / MC NYLON	50	157	151.7	146.62	146.62	65	35	STEEL / S45C / SUS / MC NYLON
11	38	33.81	28.73	28.38	20	20		51	160	154.73	149.65	149.57	65	35	
12	41	36.80	31.72	31.72	27	20		52	163	157.75	152.67	152.67	65	35	
13	44	39.80	34.72	34.43	27	20		53	166	160.78	155.7	155.63	65	35	
14	47	42.81	37.73	37.73	32	20		54	169	163.81	158.73	158.73	65	35	
15	51	45.81	40.73	40.48	34	20		55	172	166.85	161.77	161.70	65	35	
16	54	48.82	43.74	43.74	37	20		56	175	169.88	164.80	164.80	65	35	
17	57	51.84	46.76	46.54	40	20		57	178	172.91	167.83	167.76	65	35	
18	60	54.85	49.77	49.77	43	20		58	181	175.94	170.86	170.86	65	35	
19	63	57.87	52.79	52.59	46	20		59	184	178.97	173.89	173.82	65	35	
20	66	60.89	55.81	55.81	49	20		60	187	182.00	176.92	176.92	65	35	
21	69	63.91	58.83	58.65	50	20		61	190	185.03	179.95	179.89	65	35	
22	72	66.93	61.85	61.85	56	20		62	194	188.06	182.98	182.98	65	35	
23	75	69.95	64.87	64.71	60	20		63	197	191.09	186.01	185.95	65	35	
24	78	72.97	67.89	67.89	60	25		64	200	194.12	189.04	189.04	65	35	
25	81	76.00	70.92	70.77	60	25		65	203	197.15	192.07	192.01	70	40	
26	84	79.02	73.94	73.94	60	25		66	206	200.18	195.10	195.10	70	40	
27	87	82.05	76.97	76.83	60	25		67	209	203.21	198.13	198.08	70	40	
28	90	85.07	79.99	79.99	60	25		68	212	206.24	201.16	201.16	70	40	
29	93	88.10	82.02	82.89	60	25		69	215	209.27	204.19	204.14	70	40	
30	96	91.12	86.04	86.04	60	25		70	218	212.3	207.22	207.22	70	40	
31	99	94.15	88.07	88.95	60	25		71	221	215.34	210.26	210.20	70	40	
32	102	97.18	92.10	92.10	60	25		72	224	218.37	213.29	213.29	70	40	
33	105	100.20	95.12	95.01	60	25		73	227	221.40	216.32	216.27	70	40	
34	109	103.23	98.15	98.15	60	25		74	230	224.43	219.35	219.35	70	40	
35	112	106.26	101.18	101.07	60	25		75	233	227.46	222.38	222.33	70	40	
36	115	109.29	104.21	104.21	55	30		76	236	230.49	225.41	225.41	70	40	
37	118	112.31	107.23	107.13	55	30		77	239	233.52	228.44	228.39	70	40	
38	121	115.34	110.26	110.26	55	30		78	242	236.55	231.47	231.47	70	40	
39	124	118.37	113.29	113.20	55	30		79	245	239.58	234.50	234.46	70	40	
40	127	121.4	116.32	116.32	55	30		80	248	242.61	237.53	237.53	70	40	
41	130	124.43	119.35	119.26	60	30		81	251	245.65	240.57	240.52	70	40	
42	133	127.46	122.38	122.38	60	30		82	254	248.68	243.60	243.60	70	40	
43	136	130.49	125.41	125.32	60	30		83	257	251.71	246.63	246.58	70	40	
44	139	133.52	128.44	128.44	60	30		84	260	254.74	249.66	249.66	70	40	
45	142	136.55	131.47	131.38	60	35		85	263	257.77	252.69	252.65			
46	145	139.58	134.50	134.50	60	35		86	266	260.8	255.72	255.72			
47	148	142.61	137.53	137.45	60	35		87	269	263.83	258.75	258.71			
48	151	145.64	140.56	140.56	65	35		88	272	266.86	261.78	261.78			
49	154	148.67	143.59	143.51	65	35		90	278	272.93	267.85	267.85			

## Sprocket #RS40 (1/2" Pitch) 尺寸表

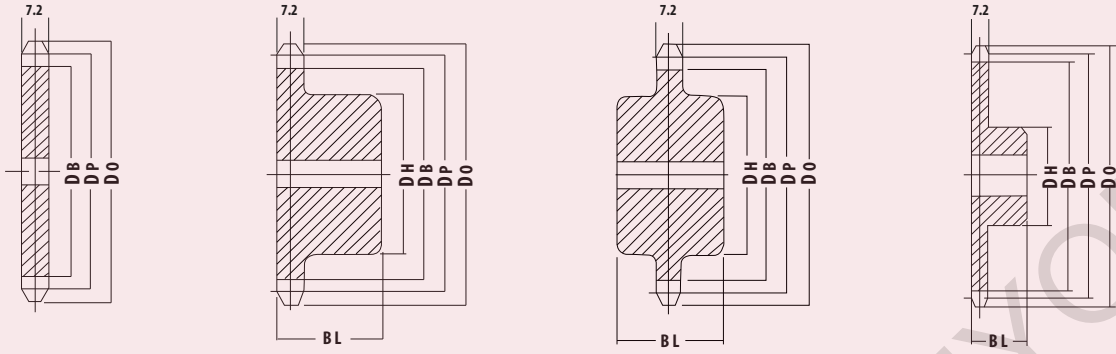

齒數 T	外徑 DO	節距徑 DP	齒底徑 DB	齒底徑 DC	輪殼		材質 MAT'	齒數 T	外徑 DO	節距徑 DP	齒底徑 DB	齒底徑 DC	輪殼		材質 MAT'
					徑 DH	長 BL							徑 DH	長 BL	
10	46	41.10	33.16	33.16	32	25	STEEL / S45C / SUS / MC NYLON	50	209	202.26	194.32	194.32	68	35	STEEL / S45C / SUS / MC NYLON
11	51	45.08	37.14	36.68	37	25		51	214	206.30	198.36	198.26	68	35	
12	55	49.07	41.13	41.13	35	25		52	218	210.34	202.40	202.40	68	35	
13	59	53.07	45.13	44.74	38	25		53	222	214.38	206.44	206.35	68	35	
14	63	57.07	49.13	49.13	42	28		54	226	218.42	210.48	210.48	68	35	
15	67	61.08	53.14	52.81	46	28		55	230	222.46	214.52	214.43	68	35	
16	71	65.10	57.16	57.16	50	28		56	234	226.50	218.56	218.56	68	35	
17	76	69.12	61.18	60.88	54	30		57	238	230.54	222.6	222.51	68	35	
18	80	73.14	65.20	65.20	54	30		58	242	234.58	226.64	226.64	68	35	
19	84	77.16	69.22	68.96	54	30		59	246	238.62	230.68	230.60	68	35	
20	88	81.18	73.24	73.24	56	35		60	250	242.66	234.72	234.72	68	35	
21	92	85.21	77.27	77.03	56	35		61	254	246.70	238.76	238.68	68	35	
22	96	89.24	81.30	81.30	56	35		62	258	250.74	242.80	242.80	68	35	
23	100	93.27	85.33	85.11	56	35		63	262	254.78	246.84	246.77	68	35	
24	104	97.30	89.36	89.36	60	35		64	266	258.83	250.89	250.89	68	35	
25	108	101.33	93.39	93.19	60	35		65	270	262.87	254.93	254.85	68	35	
26	112	105.36	97.42	97.42	60	35		66	274	266.91	258.97	258.97	68	35	
27	116	109.40	101.46	101.27	65	35		67	278	270.95	262.93	262.93	68	35	
28	120	113.43	105.49	105.49	65	35		68	282	274.99	267.05	267.05	68	35	
29	124	117.46	109.52	109.35	65	35	69	286	279.03	271.09	271.02	68	35		
30	128	121.50	113.56	113.56	65	35	70	290	283.07	275.13	275.13	73	40		
31	133	125.53	117.59	117.43	65	35	71	294	287.11	279.17	279.10	73	40		
32	137	129.57	121.63	121.63	65	35	72	299	291.16	283.22	283.22	73	40		
33	141	133.61	125.67	125.51	65	35	73	303	295.20	287.26	287.19	73	40		
34	145	137.64	129.70	129.70	65	35	74	307	299.24	291.30	291.30	73	40		
35	149	141.68	133.74	133.60	65	30	75	311	303.28	295.34	295.27	73	40		
36	153	145.72	137.78	137.78	68	35	76	315	307.32	299.38	299.38	73	40		
37	157	149.75	141.81	141.68	68	35	77	319	311.36	303.42	303.36	73	40		
38	161	153.79	145.85	145.85	68	35	78	323	315.40	307.46	307.46	73	40		
39	165	157.83	149.89	149.76	68	35	79	327	319.44	311.50	311.44	73	40		
40	169	161.87	153.93	153.93	68	35	80	331	323.49	315.55	315.55	73	40		
41	173	165.91	157.97	157.84	68	35	81	335	327.53	319.59	319.53	73	40		
42	177	169.95	162.01	162.01	68	35	82	339	331.57	323.63	323.63	73	40		
43	181	173.98	166.04	165.93	68	35	83	343	335.61	327.67	327.61	73	40		
44	185	178.02	170.08	170.08	68	35	84	347	339.65	331.71	331.71	73	40		
45	189	182.06	174.12	174.01	68	35	85	351	343.69	335.75	335.70	73	40		
46	193	186.10	178.16	178.16	68	35	86	355	347.73	339.79	339.79	73	40		
47	197	190.14	182.20	182.10	68	35	87	359	351.78	343.84	343.78	73	40		
48	201	194.18	186.24	186.24	68	35	88	363	355.82	347.88	347.88	73	40		
49	205	198.22	190.28	190.18	68	35	90	371	363.9	355.96	355.96	73	40		

## Sprocket #RS50 (5/8" Pitch) 尺寸表

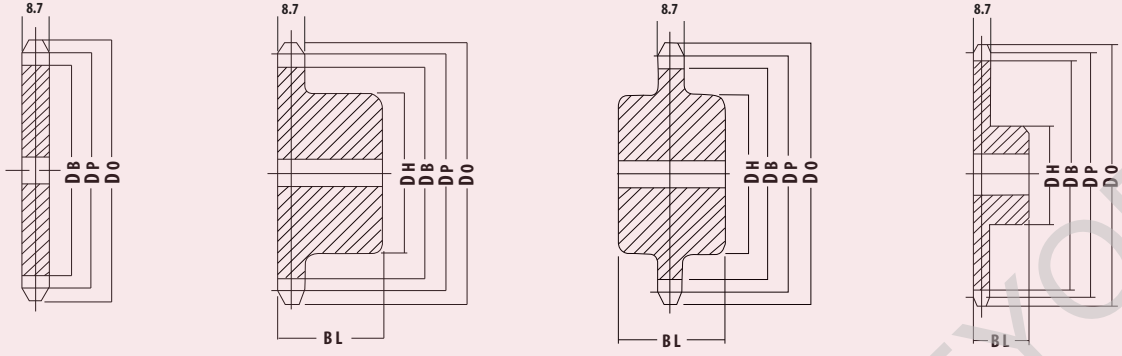

齒數 T	外徑 DO	節距徑 DP	齒底徑 DB	齒底徑 DC	輪殼		材質 MAT'	齒數 T	外徑 DO	節距徑 DP	齒底徑 DB	齒底徑 DC	輪殼		材質 MAT'
					徑 DH	長 BL							徑 DH	長 BL	
10	58	51.38	41.22	41.22	40	30	STEEL / S45C / SUS / MC NYLON	50	262	252.83	242.67	242.67	73	40	STEEL / S45C / SUS / MC NYLON
11	63	56.35	46.19	45.61	46	30		51	267	257.88	247.72	247.59	73	40	
12	68	61.34	51.18	51.18	43	30		52	272	262.92	252.76	252.76	73	40	
13	73	66.34	56.18	55.69	48	30		53	277	267.97	257.81	257.70	73	40	
14	79	71.34	61.18	61.18	53	30		54	282	273.02	262.86	262.86	73	40	
15	84	76.35	66.19	65.78	58	35		55	287	278.08	267.92	267.80	73	40	
16	89	81.37	71.21	71.21	63	35		56	292	283.13	272.97	272.97	73	40	
17	94	86.39	76.23	75.87	65	35		57	297	288.18	278.02	277.91	73	40	
18	99	91.42	81.26	81.26	65	35		58	302	293.23	283.07	283.07	73	40	
19	104	96.45	86.29	85.96	65	35		59	307	298.28	288.12	288.01	73	40	
20	109	101.48	91.32	91.32	70	40		60	312	303.33	293.17	293.17	73	40	
21	114	106.51	96.35	96.05	70	40		61	318	308.38	298.22	298.12	73	40	
22	119	111.55	101.39	101.39	70	40		62	323	313.43	303.27	303.27	73	40	
23	124	116.58	106.42	106.15	70	40		63	328	318.48	308.32	308.22	73	40	
24	129	121.62	111.46	111.46	70	40		64	333	323.53	313.37	313.37	73	40	
25	134	126.66	116.50	116.25	70	40		65	338	328.58	318.42	318.33	73	40	
26	139	131.7	121.54	121.54	70	40		66	343	333.64	323.48	323.48	73	40	
27	144	136.74	126.58	126.35	70	40		67	348	338.69	328.53	328.43	73	40	
28	149	141.79	131.63	131.63	70	40		68	353	343.74	333.58	333.58	73	40	
29	154	146.83	136.67	136.45	70	40		69	358	348.79	338.63	338.54	73	40	
30	160	151.87	141.71	141.71	70	40		70	363	353.84	343.68	343.68	93	45	
31	165	156.92	146.76	146.55	70	40		71	368	358.89	348.73	348.64	93	45	
32	170	161.96	151.80	151.80	70	40		72	373	363.94	353.78	353.78	93	45	
33	175	167.01	156.85	156.66	70	40		73	378	369.00	358.84	358.75	93	45	
34	180	172.05	161.89	161.89	70	40	74	383	374.05	363.89	363.89	93	45		
35	185	177.10	166.94	166.76	70	40	75	388	379.10	368.94	368.86	93	45		
36	191	182.14	171.98	171.98	73	40	76	393	384.15	373.99	373.99	93	45		
37	196	187.19	177.03	176.86	73	40	77	398	389.20	379.04	378.96	93	45		
38	201	192.24	182.08	182.08	73	40	78	403	394.25	384.09	384.09	93	45		
39	206	197.29	186.13	186.97	73	40	79	409	399.31	389.15	389.07	93	45		
40	211	202.33	192.17	192.17	73	40	80	414	404.36	394.20	394.20	93	45		
41	216	207.38	197.22	197.07	73	40	81	419	409.41	399.25	399.17	93	45		
42	221	212.43	202.27	202.27	73	40	82	424	414.46	404.30	404.30	93	45		
43	226	217.48	207.18	207.32	73	40	83	429	419.51	409.35	409.28	93	45		
44	231	222.53	212.37	212.37	73	40	84	434	424.57	414.41	414.41	93	45		
45	237	227.58	217.42	217.28	73	40	85	439	429.62	419.46	419.39	93	45		
46	242	232.63	222.47	222.47	73	40	86	444	434.67	424.51	424.51	93	45		
47	247	237.68	227.52	227.38	73	40	87	449	439.72	429.56	429.40	93	45		
48	252	242.73	232.57	232.57	73	40	88	454	444.77	434.61	434.61	93	45		
49	257	247.78	237.62	237.49	73	40	90	464	454.88	444.72	444.72	93	45		

## Sprocket #RS60 (3/4" Pitch) 尺寸表

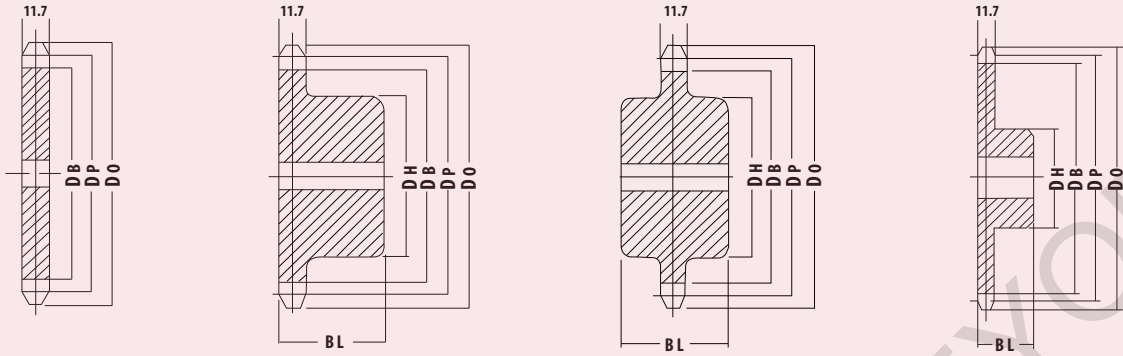

齒數 T	外徑 DO	節距徑 DP	齒底徑 DB	齒底徑 DC	輪殼		材質 MAT'	齒數 T	外徑 DO	節距徑 DP	齒底徑 DB	齒底徑 DC	輪殼		材質 MAT'
					徑 DH	長 BL							徑 DH	長 BL	
10	70	61.65	49.74	49.74	49	35	STEEL / S45C / SUS / MC NYLON	50	314	303.39	291.48	291.48	83	50	STEEL / S45C / SUS / MC NYLON
11	76	67.62	55.71	55.02	51	35		51	320	309.45	297.54	297.39	83	50	
12	83	73.60	61.69	61.69	51	35		52	326	315.51	303.60	303.60	83	50	
13	89	79.60	67.69	67.11	56	35		53	332	321.57	309.66	309.52	83	50	
14	95	85.61	73.70	73.70	62	40		54	338	327.63	315.72	315.72	83	50	
15	101	91.62	79.71	79.21	68	40		55	345	333.69	321.78	321.64	83	50	
16	107	97.65	85.74	85.74	70	40		56	351	339.75	327.84	327.84	83	50	
17	113	103.67	91.76	91.32	70	40		57	357	345.81	333.90	333.77	83	50	
18	119	109.71	97.8	97.80	70	40		58	363	351.87	339.96	339.96	83	50	
19	126	115.74	103.83	103.43	70	40		59	369	357.93	346.02	345.90	83	50	
20	132	121.78	109.87	109.87	80	45		60	375	363.99	352.08	352.08	83	50	
21	138	127.82	115.91	115.55	80	45		61	381	370.06	358.15	358.02	83	50	
22	144	133.86	121.95	121.95	80	45		62	387	376.12	364.21	364.21	83	50	
23	150	139.90	127.99	127.67	80	45		63	393	382.18	370.27	370.15	83	50	
24	156	145.95	164.04	134.04	80	45		64	399	388.24	376.33	376.33	83	50	
25	162	151.99	140.08	139.79	80	45		65	405	394.30	382.39	382.28	83	50	
26	168	158.04	146.13	146.13	80	45		66	411	400.36	388.45	388.45	83	50	
27	174	164.09	152.18	151.90	80	45		67	417	406.42	394.51	394.40	83	50	
28	180	170.14	158.23	158.23	85	45		68	423	412.49	400.58	400.58	83	50	
29	187	176.20	164.29	164.03	85	45	69	430	418.55	406.64	406.53	83	50		
30	193	182.25	170.34	170.34	85	50	70	436	424.61	412.70	412.70	108	70		
31	199	188.3	176.39	176.15	85	50	71	442	430.67	418.76	418.65	108	70		
32	205	194.35	182.44	182.44	85	50	72	448	436.73	424.82	424.82	108	70		
33	211	200.41	188.50	188.27	85	50	73	454	442.79	430.88	430.78	108	70		
34	217	206.46	194.55	194.55	85	50	74	460	448.86	436.95	436.95	108	70		
35	223	212.52	200.61	200.39	85	50	75	466	454.92	443.01	442.91	108	70		
36	229	218.57	206.66	206.66	83	50	76	472	460.98	449.07	449.07	108	70		
37	235	224.63	212.72	212.52	83	50	77	478	467.04	455.13	455.04	108	70		
38	241	230.69	218.78	218.78	83	50	78	484	473.10	461.19	461.19	108	70		
39	247	236.74	224.83	224.64	83	50	79	490	479.17	467.26	467.16	108	70		
40	253	242.80	230.89	230.89	83	50	80	496	485.23	473.32	473.32	108	70		
41	260	248.86	236.95	236.77	83	50	81	502	491.29	479.38	479.29	108	70		
42	266	254.92	243.01	243.01	83	50	82	508	497.35	485.44	485.44	108	70		
43	272	260.98	249.07	248.89	83	50	83	514	503.42	491.51	491.42	108	70		
44	278	267.03	255.12	255.12	83	50	84	521	509.48	497.57	497.57	108	70		
45	284	273.09	261.18	261.02	83	50	85	527	515.54	503.63	503.54	108	70		
46	290	279.15	267.24	267.24	83	50	86	533	521.60	509.69	509.69	108	70		
47	296	285.21	273.30	273.14	83	50	87	539	527.67	515.76	515.67	108	70		
48	302	291.27	279.36	279.36	83	50	88	545	533.73	521.82	521.82	108	70		
49	308	297.33	285.42	285.27	83	50	90	557	545.85	533.94	533.94	108	70		



**Sprocket #RS80 (1" Pitch) 尺寸表**

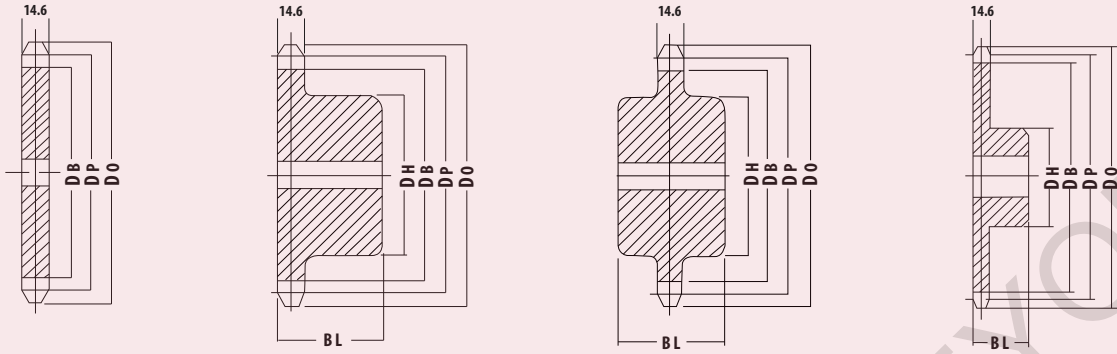

齒數 T	外徑 DO	節距徑 DP	齒底徑 DB	齒底徑 DC	輪殼		材質 MAT'	齒數 T	外徑 DO	節距徑 DP	齒底徑 DB	齒底徑 DC	輪殼		材質 MAT'
					徑 DH	長 BL							徑 DH	長 BL	
10	93	82.19	66.31	66.31	55	45	STEEL / S45C / SUS / MC NYLON	50	419	404.52	388.64	388.64	108	60	STEEL / S45C / SUS / MC NYLON
11	102	90.16	74.28	73.36	60	45		51	427	412.60	396.72	396.52	108	60	
12	110	98.14	82.26	82.26	69	45		52	435	420.68	404.80	404.80	108	60	
13	118	106.14	90.26	89.48	77	50		53	443	428.76	412.88	412.69	108	60	
14	127	114.15	98.27	98.27	80	50		54	451	436.84	420.96	420.96	108	60	
15	135	122.17	106.29	105.62	80	50		55	459	444.92	429.04	428.86	108	60	
16	143	130.20	114.32	114.32	80	50		56	468	453.00	437.12	437.12	108	60	
17	151	138.23	122.35	121.76	90	50		57	476	461.08	445.20	445.03	108	60	
18	159	146.27	130.39	130.39	90	50		58	484	469.16	453.28	453.28	108	60	
19	167	154.32	138.44	137.91	90	50		59	492	477.25	461.37	461.20	108	60	
20	176	162.37	146.49	146.49	90	50		60	500	485.33	469.45	469.45	108	60	
21	184	170.42	154.54	154.06	90	50		61	508	493.41	477.53	477.36	108	60	
22	192	178.48	162.60	162.60	93	50		62	516	501.49	485.61	485.61	108	60	
23	200	186.54	170.66	170.22	93	50		63	524	509.57	493.69	493.53	108	60	
24	208	194.60	178.72	178.72	93	50		64	532	517.65	501.77	501.77	108	60	
25	216	202.66	186.78	186.38	93	50		65	540	525.73	509.85	509.70	108	60	
26	224	210.72	194.84	194.84	93	50		66	548	533.82	517.94	517.94	108	60	
27	233	218.79	202.91	202.54	93	50		67	557	541.90	526.02	525.87	108	60	
28	241	226.86	210.98	210.98	93	50		68	565	549.98	534.10	534.10	108	60	
29	249	234.93	219.05	218.70	93	50	69	573	558.06	542.18	542.04	108	60		
30	257	243.00	227.12	227.12	93	50	70	581	566.15	550.27	550.27	108	60		
31	265	251.07	235.19	234.86	93	50	71	589	574.23	558.35	558.21	108	60		
32	273	259.14	243.26	243.26	93	50	72	597	582.31	566.43	566.43	108	60		
33	281	267.21	251.33	251.03	93	50	73	605	590.39	574.51	574.38	108	60		
34	289	275.29	259.41	259.41	93	50	74	613	598.47	582.59	582.59	108	60		
35	297	283.36	267.48	267.19	93	50	75	621	606.56	590.68	590.54	108	60		
36	306	291.43	275.55	275.55	93	50	76	629	614.64	598.76	598.76	108	60		
37	314	299.51	283.63	283.36	93	50	77	637	622.72	606.84	606.71	108	60		
38	322	307.58	291.70	291.70	93	50	78	646	630.81	614.93	614.93	108	60		
39	330	315.66	299.78	299.52	93	50	79	654	638.89	623.01	622.88	108	60		
40	338	323.74	307.86	307.86	108	60	80	662	646.97	631.09	631.09	108	60		
41	346	331.81	315.93	315.69	108	60	81	670	655.06	639.18	639.05				
42	354	339.89	324.01	324.01	108	60	82	678	663.14	647.26	647.26				
43	362	347.97	332.09	331.86	108	60	83	686	671.22	655.22	655.22				
44	370	356.04	340.16	340.16	108	60	84	694	679.31	663.43	663.43				
45	378	364.12	348.24	348.02	108	60	85	702	687.39	671.39	671.39				
46	387	372.2	356.32	356.32	108	60	86	710	695.47	679.59	679.59				
47	395	380.28	364.4	364.19	108	60	87	718	703.55	687.56	687.56				
48	403	388.36	372.48	372.48	108	60	88	726	711.64	695.76	695.76				
49	411	396.44	380.56	380.36	108	60	90	743	727.80	711.92	711.92				

**Sprocket #RS100 (1 1/4" Pitch) 尺寸表**

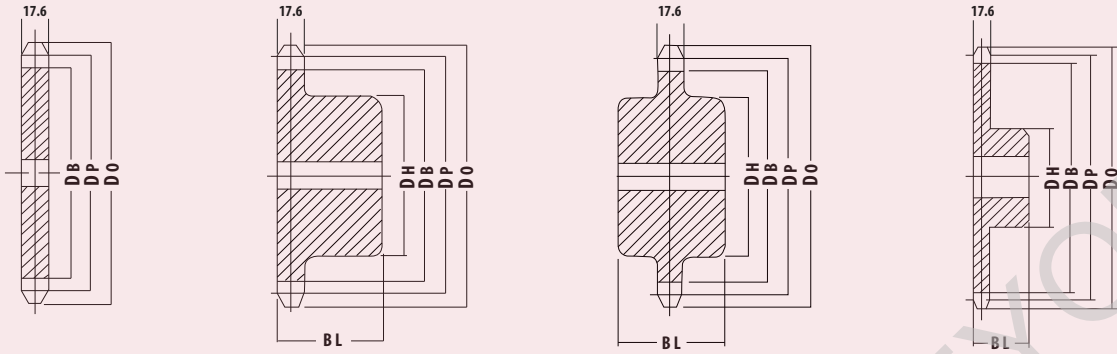

齒數 T	外徑 DO	節距徑 DP	齒底徑 DB	齒底徑 DC	輪殼		材質 MAT'	齒數 T	外徑 DO	節距徑 DP	齒底徑 DB	齒底徑 DC	輪殼		材質 MAT'
					徑 DH	長 BL							徑 DH	長 BL	
10	116	102.74	83.69	83.69	65	60	STEEL / S45C / SUS / MC NYLON	50	524	505.65	486.60	486.6	117	70	STEEL / S45C / SUS / MC NYLON
11	127	112.70	93.65	92.50	76	60		51	534	515.75	496.70	496.46	117	70	
12	137	122.67	103.62	103.62	86	60		52	544	525.85	506.80	506.80	117	70	
13	148	132.67	113.62	112.65	96	60		53	554	535.95	516.90	516.66	117	70	
14	158	142.68	123.63	123.63	100	60		54	564	546.05	527.00	527.00	117	70	
15	168	152.71	133.66	132.82	100	60		55	574	556.15	537.10	536.87	117	70	
16	179	162.74	143.69	143.69	100	60		56	584	566.25	547.20	547.20	117	70	
17	189	172.79	153.74	153.00	105	60		57	595	576.35	557.30	557.09	117	70	
18	199	182.84	163.79	163.79	105	60		58	605	586.45	567.40	567.40	117	70	
19	209	192.90	173.85	173.19	105	60		59	615	596.56	577.51	577.29	117	70	
20	220	202.96	183.91	183.91	105	60		60	625	606.66	587.61	587.61	117	70	
21	230	213.03	193.98	193.38	105	60		61	635	616.76	597.71	597.50	117	70	
22	240	223.10	204.05	204.05	108	60		62	645	626.86	607.81	607.81	117	70	
23	250	233.17	214.12	213.58	108	60		63	655	636.96	617.91	617.72	117	70	
24	260	243.25	224.20	224.20	108	60		64	665	647.06	628.01	628.01	117	70	
25	270	253.32	234.27	233.78	108	60		65	675	657.17	638.12	637.93	117	70	
26	281	263.40	244.35	244.35	108	60		66	686	667.27	648.22	648.22	117	70	
27	291	273.49	254.44	253.97	108	60		67	696	677.37	658.32	658.14	117	70	
28	301	283.57	264.52	264.52	108	60		68	706	687.48	668.43	668.43	117	70	
29	311	293.66	274.61	274.18	108	60		69	716	697.58	678.53	678.35	117	70	
30	321	303.75	284.70	284.70	108	60		70	726	707.68	688.63	688.63	117	70	
31	331	313.83	294.78	294.38	117	65		71	736	717.78	698.73	698.56	117	70	
32	341	323.92	304.87	304.87	117	65		72	746	727.89	708.84	708.84	117	70	
33	352	334.01	314.96	314.59	117	65		73	756	737.99	718.94	718.77	117	70	
34	362	344.11	325.06	325.06	117	65	74	766	748.09	729.04	729.04	117	70		
35	372	354.20	335.15	334.79	117	65	75	777	758.20	739.15	738.98	117	70		
36	382	364.29	345.24	345.24	117	65	76	787	768.3	749.25	749.25	117	70		
37	392	374.38	355.33	355.00	117	65	77	797	778.41	759.36	759.19	117	70		
38	402	384.48	365.43	365.43	117	65	78	807	788.51	769.46	769.46	117	70		
39	412	394.57	375.52	375.20	117	65	79	817	798.61	779.56	779.4	117	70		
40	422	404.67	385.62	385.62	117	70	80	827	808.71	789.66	789.66	117	70		
41	433	414.77	395.72	395.41	117	70	81	837	818.82	799.77	799.61	117	70		
42	443	424.86	405.81	405.81	117	70	82	847	828.92	809.87	809.87	117	70		
43	453	434.96	415.91	415.62	117	70	83	857	839.03	819.98	819.83	117	70		
44	463	445.06	426.01	426.01	117	70	84	868	849.13	830.08	830.08	117	70		
45	473	455.16	436.11	435.83	117	70	85	878	859.23	840.18	840.04	117	70		
46	483	465.25	446.20	446.20	117	70	86	888	869.34	850.29	850.29	117	70		
47	493	475.35	456.30	456.04	117	70	87	898	879.44	860.39	860.25	117	70		
48	503	485.45	466.40	466.40	117	70	88	908	889.55	870.50	870.50	117	70		
49	514	495.55	476.50	476.25	117	70	89	918	899.65	880.60	880.60	117	70		
							90	928	909.75	890.70	890.70	117	70		

**Sprocket #RS120 (1 1/2" Pitch) 尺寸表**

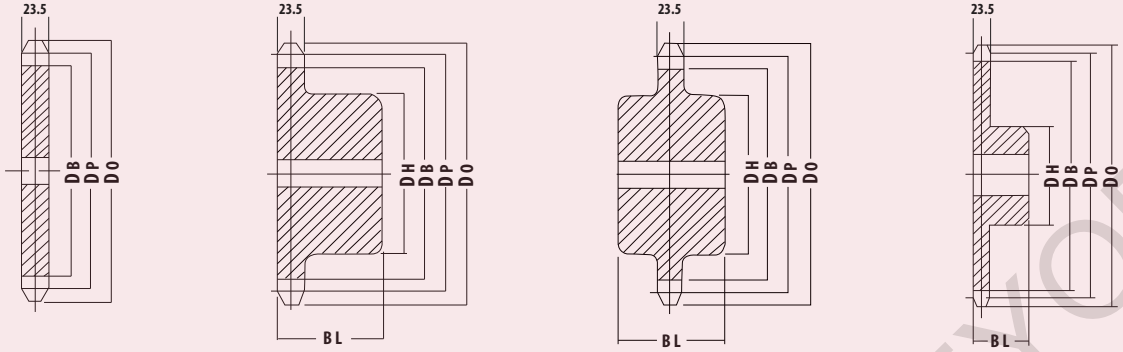

齒數 T	外徑 DO	節距徑 DP	齒底徑 DB	齒底徑 DC	輪殼		材質 MAT'	齒數 T	外徑 DO	節距徑 DP	齒底徑 DB	齒底徑 DC	輪殼		材質 MAT'
					徑 DH	長 BL							徑 DH	長 BL	
10	140	123.29	101.06	101.06	80	60	STEEL / S45C / SUS / MC NYLON	50	628	606.78	584.55	584.55	137	80	STEEL / S45C / SUS / MC NYLON
11	153	135.24	113.01	111.63	90	60		51	641	618.90	596.67	596.38	137	80	
12	165	147.21	124.98	124.98	100	60		52	654	631.02	608.79	608.79	137	80	
13	177	159.2	136.97	135.81	105	60		53	665	643.14	620.91	620.63	137	80	
14	190	171.22	148.99	148.99	105	60		54	677	655.26	633.03	633.03	137	80	
15	202	183.25	161.02	160.02	105	60		55	689	667.38	645.15	644.88	137	80	
16	214	195.29	173.06	173.06	115	70		56	701	679.50	657.27	657.27	137	80	
17	227	207.35	185.12	184.23	115	70		57	713	691.63	669.40	669.13	137	80	
18	239	219.41	197.18	197.18	120	70		58	726	703.75	681.52	681.52	137	80	
19	251	231.48	209.25	208.46	120	70		59	738	715.87	693.64	693.38	137	80	
20	263	243.55	221.32	221.32	120	70		60	750	727.99	705.76	705.76	137	80	
21	276	255.63	233.40	232.69	120	70		61	762	740.11	717.88	717.63	137	80	
22	288	267.72	245.49	245.49	117	70		62	774	752.23	730.00	730.00	137	80	
23	300	279.80	257.57	256.92	117	70		63	786	764.35	742.12	741.89	137	80	
24	312	291.90	269.67	269.67	117	70		64	798	776.48	754.25	754.25	137	80	
25	324	303.99	281.76	281.16	117	70		65	811	788.60	766.37	766.14	137	80	
26	337	316.09	293.86	293.86	117	70		66	823	800.72	778.49	778.49	137	80	
27	349	328.19	305.96	305.40	117	70		67	835	812.85	790.62	790.39	137	80	
28	361	340.29	318.06	318.06	117	70		68	847	824.97	802.74	802.74	137	80	
29	373	352.39	330.16	329.64	117	70		69	859	837.1	814.87	814.65	137	80	
30	385	364.50	342.27	342.27	127	75		70	871	849.22	826.99	826.99	137	80	
31	398	376.60	354.37	353.89	127	75		71	883	861.34	839.11	838.90			
32	410	388.71	366.48	366.48	127	75		72	896	873.47	851.24	851.24			
33	422	400.82	378.59	378.13	127	75		73	908	885.59	863.36	863.15			
34	434	412.93	390.70	390.70	127	75		74	920	897.71	875.48	875.48			
35	446	425.04	402.81	402.38	127	75		75	932	909.84	887.61	887.41			
36	458	437.15	414.92	414.92	127	75		76	944	921.96	899.73	899.73			
37	470	449.26	427.03	426.63	127	75		77	956	934.09	911.86	911.66			
38	483	461.38	439.15	439.15	127	75		78	968	946.21	923.98	923.98			
39	495	473.49	451.26	450.87	127	75		79	980	958.33	936.10	935.91			
40	507	485.6	463.37	463.37	127	75		80	993	970.46	948.23	948.23			
41	519	497.72	475.49	475.12	137	75		81	1005	982.58	960.35	960.17			
42	531	509.84	487.61	487.61	137	75		82	1017	994.71	972.48	972.48			
43	543	521.95	499.72	499.37	137	75		83	1029	1006.83	984.60	984.42			
44	556	534.07	511.84	511.84	137	75		84	1041	1018.96	996.73	996.73			
45	568	546.19	523.96	523.62	137	75		85	1053	1031.08	1008.85	1008.68			
46	580	558.3	536.07	536.07	137	75		86	1065	1043.20	1020.97	1020.97			
47	592	570.42	548.19	547.88	137	75		87	1078	1055.33	1033.10	1032.93			
48	604	582.54	560.31	560.31	137	75		88	1090	1067.46	1045.23	1045.23			
49	616	594.66	572.43	572.13	137	75		90	1114	1091.71	1069.48	1069.48			

## Sprocket #RS140 (1 3/4" Pitch) 尺寸表

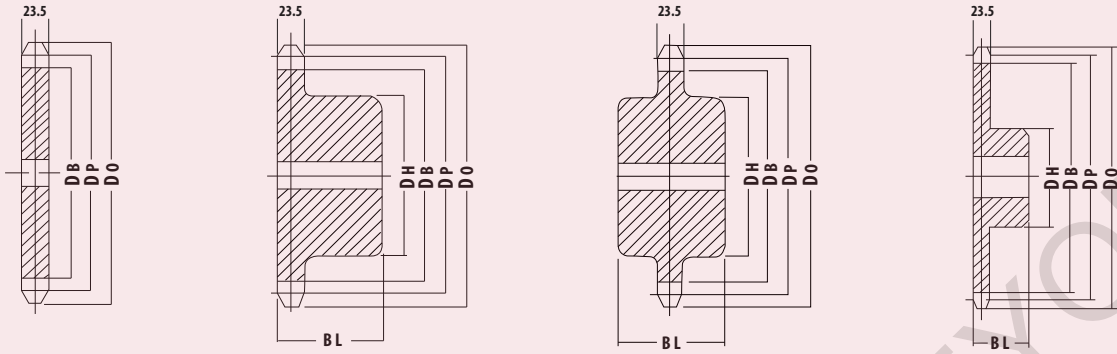

齒數 T	外徑 DO	節距徑 DP	齒底徑 DB	齒底徑 DC	輪殼		材質 MAT'	齒數 T	外徑 DO	節距徑 DP	齒底徑 DB	齒底徑 DC	輪殼		材質 MAT'
					徑 DH	長 BL							徑 DH	長 BL	
10	163	143.84	118.44	118.44	100	70	STEEL / S45C / SUS / MC NYLON	50	733	707.91	682.51	682.51	190	140	STEEL / S45C / SUS / MC NYLON
11	178	157.78	132.38	130.77	100	70		51	747	722.05	696.65	696.31	190	140	
12	193	171.74	146.34	146.34	105	70		52	762	736.19	710.79	710.79	190	140	
13	207	185.74	160.34	158.98	105	70		53	776	750.33	724.93	724.60	190	140	
14	221	199.76	174.36	174.36	115	80		54	790	764.47	739.07	739.07	190	140	
15	236	213.79	188.39	187.22	115	80		55	804	778.61	753.21	752.89	190	140	
16	250	227.84	202.44	202.44	120	80		56	818	792.75	767.35	767.35	190	140	
17	264	241.91	216.51	215.47	120	80		57	832	806.90	781.50	781.19	190	140	
18	279	255.98	230.58	230.58	120	80		58	847	821.04	795.64	795.64	190	140	
19	293	270.06	244.66	243.74	130	85		59	861	835.18	809.78	809.48	190	140	
20	307	284.15	258.75	258.75	130	85		60	875	849.32	823.92	823.92	190	140	
21	322	298.24	272.84	272.00	130	85		61	889	863.46	838.06	837.77			
22	336	312.34	286.94	286.94	140	100		62	903	877.61	852.21	852.21			
23	350	326.44	301.04	300.28	140	100		63	917	891.75	866.35	866.07			
24	364	340.54	315.14	315.14	140	100		64	931	905.89	880.49	880.49			
25	379	354.65	329.25	328.56	150	110		65	946	920.03	894.63	894.37			
26	393	368.77	343.37	343.37	150	110		66	960	934.18	908.78	908.78			
27	407	382.88	357.48	356.83	150	110		67	974	948.32	922.92	922.66			
28	421	397.00	371.60	371.60	150	110		68	988	962.47	937.07	937.07			
29	435	411.12	385.72	385.12	150	110	69	1002	976.61	951.21	950.96				
30	450	425.24	399.84	399.84	150	110	70	1016	990.75	965.35	965.35				
31	464	439.37	413.97	413.40	150	110	71	1031	1004.90	979.50	979.25				
32	478	453.49	428.09	428.09	150	110	72	1045	1019.04	993.64	993.64				
33	492	467.62	442.22	441.69	150	110	73	1059	1033.19	1007.79	1007.55				
34	506	481.75	456.35	456.35	150	110	74	1073	1047.33	1021.93	1021.93				
35	521	495.88	470.48	469.98	150	110	75	1087	1061.47	1036.07	1035.84				
36	535	510.01	484.41	484.61	165	120	76	1101	1075.62	1050.22	1050.22				
37	549	524.14	498.74	498.27	165	120	77	1116	1089.77	1064.37	1064.14				
38	563	538.27	512.87	512.87	165	120	78	1130	1103.91	1078.51	1078.51				
39	577	552.40	527.00	526.55	165	120	79	1144	1118.06	1092.66	1092.43				
40	591	566.54	541.14	541.14	165	120	80	1158	1132.00	1106.80	1106.80				
41	606	580.67	555.27	554.85	165	120	81	1172	1146.35	1120.95	1120.73				
42	620	594.81	569.41	569.41	165	120	82	1186	1160.49	1135.09	1135.09				
43	634	608.94	583.54	583.14	165	120	83	1200	1174.64	1149.24	1149.03				
44	648	623.08	597.68	597.68	165	120	84	1215	1188.78	1163.38	1163.38				
45	662	637.22	611.82	611.43	165	120	85	1229	1202.93	1177.53	1177.33				
46	676	651.35	625.95	625.95	165	120	86	1243	1217.07	1191.67	1191.67				
47	691	665.49	640.09	639.72	165	120	87	1257	1231.22	1205.82	1205.62				
48	705	679.63	654.23	654.23	165	120	88	1271	1245.36	1219.96	1219.96				
49	719	693.77	668.37	668.02	165	120	89	1285	1259.50	1234.10	1233.90				
							90	1300	1273.66	1248.26	1248.26				

**Sprocket #RS160 (2" Pitch) 尺寸表**

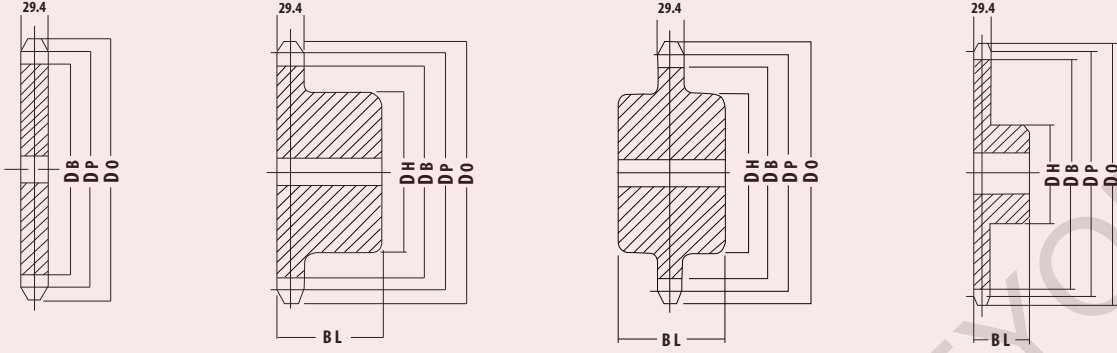

齒數 T	外徑 DO	節距徑 DP	齒底徑 DB	齒底徑 DC	輪殼		材質 MAT'	齒數 T	外徑 DO	節距徑 DP	齒底徑 DB	齒底徑 DC	輪殼		材質 MAT'
					徑 DH	長 BL							徑 DH	長 BL	
10	186	164.39	135.81	135.81	100	70	STEEL / S45C / SUS / MC NYLON	50	838	809.04	780.46	780.46			STEEL / S45C / SUS / MC NYLON
11	204	180.31	151.73	149.90	120	80		51	854	825.20	796.62	796.23			
12	220	196.28	167.70	167.70	120	80		52	870	841.36	812.78	812.78			
13	237	212.27	183.69	182.14	130	90		53	887	857.52	828.94	828.56			
14	253	228.30	199.72	199.72	130	90		54	903	873.68	845.10	845.10			
15	269	244.33	215.72	214.42	130	90		55	919	889.84	861.26	860.90			
16	286	260.39	231.81	231.81	130	90		56	935	906.00	877.42	877.42			
17	302	276.46	247.88	246.71	140	100		57	951	922.17	893.59	893.24			
18	319	292.55	263.97	263.97	140	100		58	967	938.33	909.75	909.75			
19	335	308.64	280.06	279.00	140	100		59	984	954.49	925.91	925.57			
20	351	324.74	296.16	296.16	140	100		60	1000	970.65	942.07	942.07			
21	368	340.84	312.26	311.31	140	100		61	1016	986.82	958.24	957.91			
22	384	356.96	328.38	328.38	140	100		62	1032	1002.98	974.40	974.40			
23	400	373.07	344.49	343.62	140	100		63	1048	1019.14	990.56	990.24			
24	416	389.19	360.61	360.61	140	100		64	1065	1035.30	1006.72	1006.72			
25	433	405.32	376.74	375.94				65	1081	1051.47	1022.89	1022.58			
26	449	421.45	392.87	392.87				66	1097	1067.63	1039.05	1039.05			
27	465	437.58	409.00	408.26				67	1113	1083.80	1055.22	1054.92			
28	481	453.72	425.14	425.14				68	1129	1099.96	1071.38	1071.38			
29	498	469.85	441.27	440.58				69	1145	1116.13	1087.55	1087.26			
30	514	485.99	457.41	457.41				70	1162	1132.29	1103.71	1103.71			
31	530	502.13	473.55	472.91				71	1178	1148.46	1119.88	1119.59			
32	546	518.28	489.70	489.70				72	1194	1164.62	1136.04	1136.04			
33	562	534.42	505.84	505.24				73	1210	1180.79	1152.21	1151.93			
34	579	550.57	521.99	521.99			74	1226	1196.95	1168.37	1168.37				
35	595	566.71	538.13	537.57			75	1243	1213.11	1184.53	1184.27				
36	611	582.86	554.28	554.28			76	1259	1229.28	1200.70	1200.70				
37	627	599.01	570.43	569.89			77	1275	1245.45	1216.87	1216.61				
38	644	615.17	586.59	586.59			78	1291	1261.61	1233.03	1233.03				
39	660	631.32	602.74	602.22			79	1307	1277.78	1249.20	1248.94				
40	676	647.47	618.89	618.89			80	1323	1293.94	1265.36	1265.36				
41	692	663.63	635.05	634.56			81	1340	1310.11	1281.53	1281.28				
42	708	679.78	651.20	651.20			82	1356	1326.28	1297.70	1297.70				
43	725	695.93	667.35	666.89			83	1372	1342.45	1313.87	1313.62				
44	741	712.09	683.51	683.51			84	1388	1358.61	1330.03	1330.03				
45	757	728.25	699.67	699.23			85	1404	1374.78	1346.20	1345.97				
46	773	744.40	715.82	715.82			86	1420	1390.94	1362.36	1362.36				
47	789	760.56	731.98	731.56			87	1437	1407.11	1378.53	1378.30				
48	806	776.72	748.14	748.14			88	1453	1423.27	1394.69	1394.69				
49	822	792.88	764.30	763.89			90	1485	1455.61	1427.03	1427.03				

## Double Sprocket #RS35 (3/8" Pitch)

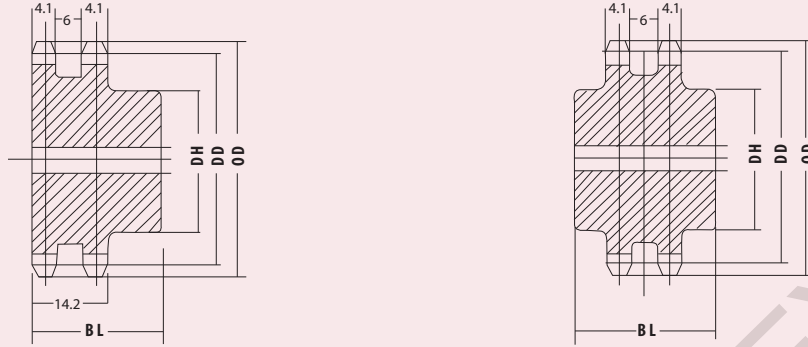

齒數 T	外徑 DO	節距徑 DP	齒底徑 DB	齒底徑 DC	輪殼		材質 MAT'	齒數 T	外徑 DO	節距徑 DP	齒底徑 DB	齒底徑 DC	輪殼		材質 MAT'	
					徑 DH	長 BL							徑 DH	長 BL		
10	35	30.84	25.78	25.78	23	32	STEEL / S45C / SUS / MC NYLON	50	157	151.70	146.62	146.62	65	40	STEEL / S45C / SUS / MC NYLON	
11	38	33.81	28.73	28.38	26	32		51	160	154.73	149.65	149.57	65	40		
12	41	36.80	31.72	31.72	27	32		52	163	157.75	152.67	152.67	65	40		
13	44	39.80	34.72	34.43	30	32		53	166	160.78	155.70	155.63	65	40		
14	47	42.81	37.73	37.73	32	32		54	169	163.81	158.73	158.73	65	40		
15	51	45.81	40.73	40.48	35	32		55	172	166.85	161.77	161.70	65	40		
16	54	48.82	43.74	43.74	38	32		56	175	169.88	164.80	164.80	65	40		
17	57	51.84	46.76	46.54	41	32		57	178	172.91	167.83	167.76	65	40		
18	60	54.85	49.77	49.77	44	32		58	181	175.94	170.86	170.86	65	40		
19	63	57.87	52.79	52.59	47	32		59	184	178.97	173.89	173.82	65	40		
20	66	60.89	55.81	55.81	50	35		60	187	182.00	176.92	176.92	65	40		
21	69	63.91	58.83	58.65	52	35		61								
22	72	66.93	61.85	61.85	56	35		62								
23	75	69.95	64.87	64.71	60	35		63								
24	78	72.97	67.89	67.89	60	35		64								
25	81	76.00	70.92	70.77	60	35		65								
26	84	79.02	73.94	73.94	60	35		66								
27	87	82.05	76.97	76.83	60	35		67								
28	90	85.07	79.99	79.99	60	35		68								
29	93	88.10	83.02	82.89	60	35		69								
30	96	91.12	86.04	86.04	60	35		70								
31	99	94.15	89.07	88.95	60	35		71								
32	102	97.18	92.10	92.10	60	35		72								
33	105	100.20	95.12	95.01	60	35		73								
34	109	103.23	98.15	98.15	60	35		74								
35	112	106.26	101.18	101.07	60	35		75								
36	115	109.29	104.21	104.21	60	35		76								
37	118	112.31	107.23	107.13	60	35		77								
38	121	115.34	110.26	110.26	60	35		78								
39	124	118.37	113.29	113.20	60	35		79								
40	127	121.40	116.32	116.32	60	40		80								
41	130	124.43	119.35	119.26	60	40		81								
42	133	127.46	122.38	122.38	60	40		82								
43	136	130.49	125.41	125.32	60	40		83								
44	139	133.52	128.44	128.44	60	40		84								
45	142	136.55	131.47	131.38	60	40		85								
46	145	139.58	134.50	134.50	60	40		86								
47	148	142.61	137.53	137.45	60	40		87								
48	151	145.64	140.56	140.56	65	40		88								
49	154	148.67	143.59	143.51	65	40		90								

**Double Sprocket #RS40 (1/2" Pitch)**

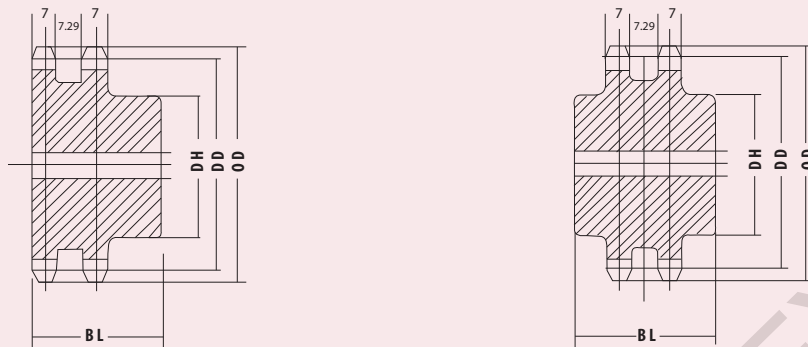

齒數 T	外徑 DO	節距徑 DP	齒底徑 DB	齒底徑 DC	輪殼		材質 MAT'	齒數 T	外徑 DO	節距徑 DP	齒底徑 DB	齒底徑 DC	輪殼		材質 MAT'
					徑 DH	長 BL							徑 DH	長 BL	
10	46	41.10	33.16	33.16	32	40		50	209	202.26	194.32	194.32	100	55	
11	51	45.08	37.14	36.68	35	40		51	214	206.30	198.36	198.26	100	55	
12	55	49.07	41.13	41.13	35	40		52	218	210.34	202.40	202.40	100	55	
13	59	53.07	45.13	44.74	39	40		53	222	214.38	206.44	206.35	100	55	
14	63	57.07	49.13	49.13	43	40		54	226	218.42	210.48	210.48	100	55	
15	67	61.08	53.14	52.81	47	40		55	230	222.46	214.52	214.43	100	55	
16	71	65.10	57.16	57.16	50	40		56	234	226.50	218.56	218.56	100	55	
17	76	69.12	61.18	60.88	54	40		57	238	230.54	222.60	222.51	100	55	
18	80	73.14	65.20	65.20	59	40		58	242	234.58	226.64	226.64	100	55	
19	84	77.16	69.22	68.96	63	40		59	246	238.62	230.68	230.60	100	55	
20	88	81.18	73.24	73.24	65	45	STEEL / S45C / SUS / MC NYLON	60	250	242.66	234.72	234.72	100	55	STEEL / S45C / SUS / MC NYLON
21	92	85.21	77.27	77.03	65	45		61							
22	96	89.24	81.30	81.30	70	45		62							
23	100	93.27	85.33	85.11	70	45		63							
24	104	97.30	89.36	89.36	75	45		64							
25	108	101.33	93.39	93.19	75	45		65							
26	112	105.36	97.42	97.42	80	45		66							
27	116	109.40	101.46	101.27	80	45		67							
28	120	113.43	105.49	105.49	80	45		68							
29	124	117.46	109.52	109.35	80	45		69							
30	128	121.50	113.56	113.56	80	45		70							
31	133	125.53	117.59	117.43	85	50		71							
32	137	129.57	121.63	121.63	85	50		72							
33	141	133.61	125.67	125.51	85	50		73							
34	145	137.64	129.70	129.70	85	50		74							
35	149	141.68	133.74	133.60	85	50		75							
36	153	145.72	137.78	137.78	85	50		76							
37	157	149.75	141.81	141.68	85	50		77							
38	161	153.79	145.85	145.85	85	50		78							
39	165	157.83	149.89	149.76	85	50		79							
40	169	161.87	153.93	153.93	90	55	80								
41	173	165.91	157.97	157.84	90	55	81								
42	177	169.95	162.01	162.01	90	55	82								
43	181	173.98	166.04	165.93	90	55	83								
44	185	178.02	170.08	170.08	90	55	84								
45	189	182.06	174.12	174.01	90	55	85								
46	193	186.10	178.16	178.16	90	55	86								
47	197	190.14	182.20	182.10	90	55	87								
48	201	194.18	186.24	186.24	90	55	88								
49	205	198.22	190.28	190.18	90	55	90								

## Double Sprocket #RS50 (5/8" Pitch)

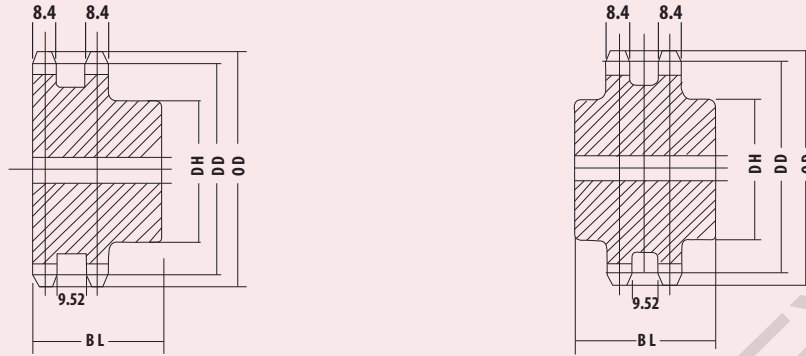

齒數 T	外徑 DO	節距徑 DP	齒底徑 DB	齒底徑 DC	輪殼		材質 MAT'	齒數 T	外徑 DO	節距徑 DP	齒底徑 DB	齒底徑 DC	輪殼		材質 MAT'
					徑 DH	長 BL							徑 DH	長 BL	
10	58	51.38	41.22	41.22	40	45	STEEL / S45C / SUS / MC NYLON	50	262	252.83	242.67	242.67	110	60	STEEL / S45C / SUS / MC NYLON
11	63	56.35	46.19	45.61	45	45		51	267	257.88	247.72	247.59	110	60	
12	68	61.34	51.18	51.18	45	45		52	272	262.92	252.76	252.76	110	60	
13	73	66.34	56.18	55.69	49	50		53	277	267.97	257.81	257.70	110	60	
14	79	71.34	61.18	61.18	54	50		54	282	273.02	262.86	262.86	110	60	
15	84	76.35	66.19	65.78	59	50		55	287	278.08	267.92	267.80	110	60	
16	89	81.37	71.21	71.21	64	50		56	292	283.13	272.97	272.97	110	60	
17	94	86.39	76.23	75.87	68	50		57	297	288.18	278.02	277.91	110	60	
18	99	91.42	81.26	81.26	74	50		58	302	293.23	283.07	283.07	110	60	
19	104	96.45	86.29	85.96	79	50		59	307	298.28	288.12	288.01	110	60	
20	109	101.48	91.32	91.32	80	55		60	312	303.33	293.17	293.17	110	60	
21	114	106.51	96.35	96.05	80	55		61							
22	119	111.55	101.39	101.39	80	55		62							
23	124	116.58	106.42	106.15	80	55		63							
24	129	121.62	111.46	111.46	80	55		64							
25	134	126.66	116.50	116.25	85	55		65							
26	139	131.70	121.54	121.54	85	55		66							
27	144	136.74	126.68	126.35	85	55		67							
28	149	141.79	131.63	131.63	85	55		68							
29	154	146.83	136.67	136.45	85	55		69							
30	160	151.87	141.71	141.71	85	55		70							
31	165	156.92	146.76	146.55	90	60		71							
32	170	161.96	151.80	151.80	90	60		72							
33	175	167.01	156.85	156.66	90	60		73							
34	180	172.05	161.89	161.89	90	60		74							
35	185	177.10	166.94	166.76	90	60		75							
36	191	182.14	171.98	171.98	90	60		76							
37	196	187.19	177.03	176.86	90	60		77							
38	201	192.24	182.08	182.08	90	60		78							
39	206	197.29	187.13	186.97	90	60		79							
40	211	202.33	192.17	192.17	95	60		80							
41	216	207.38	197.22	197.07	95	60		81							
42	221	212.43	202.27	202.27	95	60		82							
43	226	217.48	207.32	207.18	95	60		83							
44	231	222.53	212.37	212.37	95	60		84							
45	237	227.58	217.42	217.28	100	60		85							
46	242	232.63	222.47	222.47	100	60		86							
47	247	237.68	227.52	227.38	100	60		87							
48	252	242.73	232.57	232.57	100	60		88							
49	257	247.78	237.62	237.49	100	60		90							



## Double Sprocket #RS60 (3/4" Pitch)

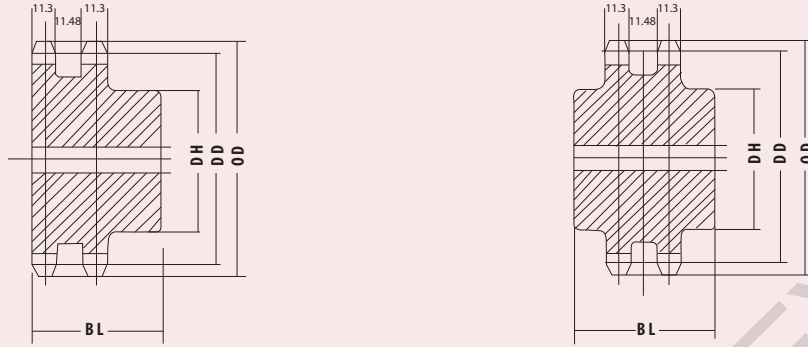

齒數 T	外徑 DO	節距徑 DP	齒底徑 DB	齒底徑 DC	輪殼		材質 MAT'	齒數 T	外徑 DO	節距徑 DP	齒底徑 DB	齒底徑 DC	輪殼		材質 MAT'
					徑 DH	長 BL							徑 DH	長 BL	
10	70	61.65	49.74	49.74	48	55	STEEL / S45C / SUS / MC NYLON	50	314	303.39	291.48	291.48	120	70	STEEL / S45C / SUS / MC NYLON
11	76	67.62	55.71	55.02	53	55		51	320	309.45	297.54	297.39	120	70	
12	83	73.60	61.69	61.69	53	55		52	326	315.51	303.60	303.60	120	70	
13	89	79.60	67.69	67.11	60	60		53	332	321.57	309.66	309.52	120	70	
14	95	85.61	73.70	73.70	66	60		54	338	327.63	315.72	315.72	120	70	
15	101	91.62	79.71	79.21	78	60		55	345	333.69	321.78	321.64	120	70	
16	107	97.65	85.74	85.74	82	65		56	351	339.75	327.84	327.84	120	70	
17	113	103.67	91.76	91.32	90	65		57	357	345.81	333.90	333.77	120	70	
18	119	109.71	97.80	97.80	94	65		58	363	351.87	339.96	339.96	120	70	
19	126	115.74	103.83	103.43	95	65		59	369	357.93	346.02	345.90	120	70	
20	132	121.78	109.87	109.87	95	65		60	375	363.99	352.08	352.08	120	70	
21	138	127.82	115.91	115.55	95	65		61							
22	144	133.86	121.95	121.95	95	65		62							
23	150	139.90	127.99	127.67	95	65		63							
24	156	145.95	134.04	134.04	95	65		64							
25	162	151.99	140.08	139.79	95	65		65							
26	168	158.04	146.13	146.13	95	65		66							
27	174	164.09	152.18	151.90	95	65		67							
28	180	170.14	158.23	158.23	95	65		68							
29	187	176.20	164.29	164.03	95	65		69							
30	193	182.25	170.34	170.34	95	65		70							
31	199	188.30	176.39	176.15	100	70		71							
32	205	194.35	182.44	182.44	100	70		72							
33	211	200.41	188.50	188.27	100	70		73							
34	217	206.46	194.55	194.55	100	70		74							
35	223	212.52	200.61	200.39	100	70		75							
36	229	218.57	206.66	206.66	100	70		76							
37	235	224.63	212.72	212.52	100	70		77							
38	241	230.69	218.78	218.78	100	70		78							
39	247	236.74	224.83	224.64	100	70		79							
40	253	242.80	230.89	230.89	110	70		80							
41	260	248.88	236.95	236.77	110	70		81							
42	266	254.92	243.01	243.01	110	70		82							
43	272	260.98	249.07	248.89	110	70		83							
44	278	267.03	255.12	255.12	110	70		84							
45	284	273.09	261.18	261.02	110	70		85							
46	290	279.15	267.24	267.24	110	70		86							
47	296	285.21	273.30	273.14	110	70		87							
48	302	291.27	279.36	279.36	110	70		88							
49	308	297.33	285.42	285.27	110	70		90							

**Double Sprocket #RS80 ( 1" Pitch)**

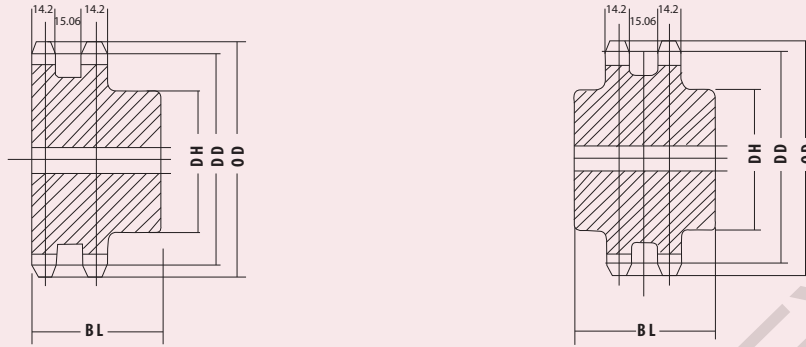

齒數 T	外徑 DO	節距徑 DP	齒底徑 DB	齒底徑 DC	輪殼		材質 MAT'	齒數 T	外徑 DO	節距徑 DP	齒底徑 DB	齒底徑 DC	輪殼		材質 MAT'	
					徑 DH	長 BL							徑 DH	長 BL		
10	93	82.19	66.31	66.31	64	75		50	419	404.52	388.64	388.64	140	90		
11	102	90.16	74.28	73.36	72	75		51	427	412.60	396.72	396.52	140	90		
12	110	98.14	82.26	82.26	72	75		52	435	420.68	404.80	404.80	140	90		
13	118	106.14	90.26	89.48	80	75		53	443	428.76	412.88	412.69	140	90		
14	127	114.15	98.27	98.27	88	75		54	451	436.84	420.96	420.96	140	90		
15	135	122.17	106.29	105.62	96	80	STEEL / S45C / SUS / MC NYLON	55	459	444.92	429.04	428.86	140	90	STEEL / S45C / SUS / MC NYLON	
16	143	130.20	114.32	114.32	100	80		56	468	453.00	437.12	437.12	140	90		
17	151	138.23	122.35	121.76	100	80		57	476	461.08	445.20	445.03	140	90		
18	159	146.27	130.39	130.39	120	80		58	484	469.16	453.28	453.28	140	90		
19	167	154.32	138.44	137.91	120	80		59	492	477.25	461.37	461.20	140	90		
20	176	162.37	146.49	146.49	120	80		60	500	485.33	469.45	469.45	140	90		
21	184	170.42	154.54	154.06	120	80		61								
22	192	178.48	162.60	162.60	120	85		62								
23	200	186.54	170.66	170.22	120	85		63								
24	208	194.60	178.72	178.72	120	85		64								
25	216	202.66	186.78	186.38	120	85		65								
26	224	210.72	194.84	194.84	120	85		66								
27	233	218.79	202.91	202.54	120	85		67								
28	241	226.86	210.98	210.98	120	85		68								
29	249	234.93	219.05	218.70	120	85		69								
30	257	243.00	227.12	227.12	120	85		70								
31	265	251.07	235.19	234.86	120	85		71								
32	273	259.14	243.26	243.26	120	85		72								
33	281	267.21	251.33	251.03	120	85		73								
34	289	275.29	259.41	259.41	120	85		74								
35	297	283.36	267.48	267.19	120	90		75								
36	306	291.43	275.55	275.55	120	90		76								
37	314	299.51	283.63	283.36	120	90		77								
38	322	307.58	291.70	291.70	120	90		78								
39	330	315.66	299.78	299.52	120	90		79								
40	338	323.74	307.86	307.86	130	90		80								
41	346	331.81	315.93	315.69	130	90		81								
42	354	339.89	324.01	324.01	130	90		82								
43	362	347.97	332.09	331.86	130	90		83								
44	370	356.04	340.16	340.16	130	90		84								
45	378	364.12	348.24	348.02	130	90		85								
46	387	372.20	356.32	356.32	130	90		86								
47	395	380.28	364.40	364.19	130	90		87								
48	403	388.36	372.48	372.48	130	90		88								
49	411	396.44	380.56	380.36	130	90		89								

**Double Sprocket #RS100 ( 1 1/4" )**

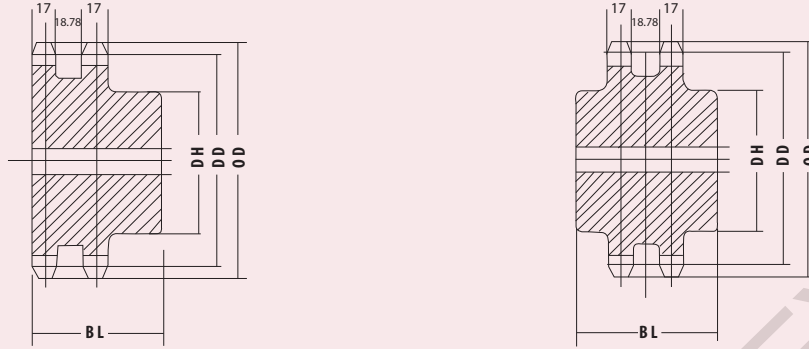

齒數 T	外徑 DO	節距徑 DP	齒底徑 DB	齒底徑 DC	輪殼		材質 MAT'	齒數 T	外徑 DO	節距徑 DP	齒底徑 DB	齒底徑 DC	輪殼		材質 MAT'
					徑 DH	長 BL							徑 DH	長 BL	
10	116	102.74	83.69	83.69	82	90	STEEL / S45C / SUS / MC NYLON	50	524	505.65	486.60	486.60	147	110	STEEL / S45C / SUS / MC NYLON
11	127	112.70	93.65	92.50	92	90		51	534	515.75	496.70	496.46	147	110	
12	137	122.67	103.62	103.62	90	90		52	544	525.85	506.80	506.80	147	110	
13	148	132.67	113.62	112.65	100	95		53	554	535.95	516.90	516.66	147	110	
14	158	142.68	123.63	123.63	110	95		54	564	546.05	527.00	527.00	147	110	
15	168	152.71	133.66	132.82	120	105		55	574	556.15	537.10	536.87	147	110	
16	179	162.74	143.69	143.69	130	105		56	584	566.25	547.20	547.20	147	110	
17	189	172.79	153.74	153.00	130	105		57	595	576.35	557.30	557.09	147	110	
18	199	182.84	163.79	163.79	130	105		58	605	586.45	567.40	567.40	147	110	
19	209	192.90	173.85	173.19	130	105		59	615	596.56	577.51	577.29	147	110	
20	220	202.96	183.91	183.91	130	105		60	625	606.66	587.61	587.61	147	110	
21	230	213.03	193.98	193.38	130	105		61							
22	240	223.10	204.05	204.05	130	105		62							
23	250	233.17	214.12	213.58	130	105		63							
24	260	243.25	224.20	224.20	137	105		64							
25	270	253.32	234.27	233.78	137	105		65							
26	281	263.40	244.35	244.35	137	105		66							
27	291	273.49	254.44	253.97	137	105		67							
28	301	283.57	264.52	264.52	137	105		68							
29	311	293.66	274.61	274.18	137	105		69							
30	321	303.75	284.70	284.70	137	105		70							
31	331	313.83	294.78	294.38	137	105		71							
32	341	323.92	304.87	304.87	137	105		72							
33	352	334.01	314.96	314.59	137	105		73							
34	362	344.11	325.06	325.06	137	105		74							
35	372	354.20	335.15	334.79	137	105		75							
36	382	364.29	345.24	345.24	137	105		76							
37	392	374.38	355.33	355.00	137	105		77							
38	402	384.48	365.43	365.43	137	105		78							
39	412	394.57	375.52	375.20	137	105		79							
40	422	404.67	385.62	385.62	147	110		80							
41	433	414.77	395.72	395.41	147	110		81							
42	443	424.86	405.81	405.81	147	110		82							
43	453	434.96	415.91	415.62	147	110		83							
44	463	445.06	426.01	426.01	147	110		84							
45	473	455.16	436.11	435.83	147	110		85							
46	483	465.25	446.20	446.20	147	110		86							
47	493	475.35	456.30	456.04	147	110		87							
48	503	485.45	466.40	466.40	147	110		88							
49	514	495.55	476.50	476.25	147	110		90							

## Double Sprocket #RS120 ( 1 1/2" Pitch)

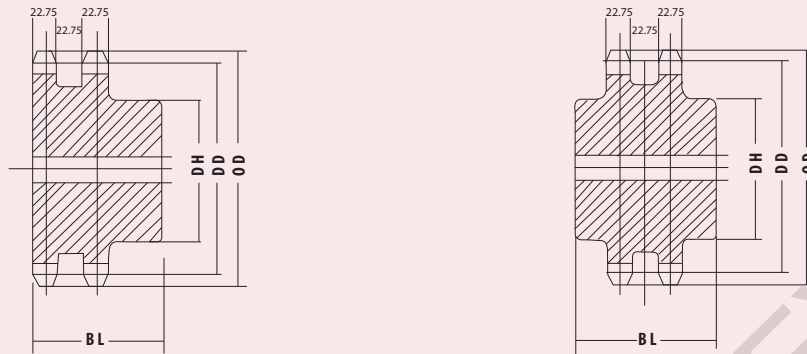

齒數 T	外徑 DO	節距徑 DP	齒底徑 DB	齒底徑 DC	輪殼		材質 MAT'	齒數 T	外徑 DO	節距徑 DP	齒底徑 DB	齒底徑 DC	輪殼		材質 MAT'	
					徑 DH	長 BL							徑 DH	長 BL		
10	140	123.29	101.06	101.06	98	105	STEEL / S45C / SUS / MC NYLON	50	628	606.78	584.55	584.55	177	130	STEEL / S45C / SUS / MC NYLON	
11	153	135.24	113.01	111.63	105	105		51	641	618.90	596.67	596.38	177	130		
12	165	147.21	124.98	124.98	105	105		52	654	631.02	608.79	608.79	177	130		
13	177	159.20	136.97	135.81	115	110		53	665	643.14	620.91	620.63	177	130		
14	190	171.22	148.99	148.99	120	110		54	677	655.26	633.03	633.03	177	130		
15	202	183.25	161.02	160.02	120	120		55	689	667.38	645.15	644.88	177	130		
16	214	195.29	173.06	173.06	140	125		56	701	679.50	657.27	657.27	177	130		
17	227	207.35	185.12	184.23	140	125		57	713	691.63	669.40	669.13	177	130		
18	239	219.41	197.18	197.18	140	125		58	726	703.75	681.52	681.52	177	130		
19	251	231.48	209.25	208.46	140	125		59	738	715.87	693.64	693.38	177	130		
20	263	243.55	221.32	221.32	140	125		60	750	727.99	705.76	705.76	177	130		
21	276	255.63	233.40	232.69	140	125		61								
22	288	267.72	245.49	245.49	140	125		62								
23	300	279.80	257.57	256.92	140	125		63								
24	312	291.90	269.67	269.67	157	125		64								
25	324	303.99	281.76	281.16	157	125		65								
26	337	316.09	293.86	293.86	157	125		66								
27	349	328.19	305.96	305.40	157	125		67								
28	361	340.29	318.06	318.06	157	125		68								
29	373	352.39	330.16	329.64	157	125		69								
30	385	364.50	342.27	342.27	157	125		70								
31	398	376.60	354.37	353.89	157	125		71								
32	410	388.71	366.48	366.48	157	125		72								
33	422	400.82	378.59	378.13	157	125		73								
34	434	412.93	390.70	390.70	157	125		74								
35	446	425.04	402.81	402.38	157	125		75								
36	458	437.15	414.92	414.92	157	125		76								
37	470	449.26	427.03	426.63	157	125		77								
38	483	461.38	439.15	439.15	157	125		78								
39	495	473.49	451.26	450.87	157	125		79								
40	507	485.60	463.37	463.37	177	130		80								
41	519	497.72	475.49	475.12	177	130		81								
42	531	509.84	487.61	487.61	177	130		82								
43	543	521.95	499.72	499.37	177	130		83								
44	556	534.07	511.84	511.84	177	130		84								
45	568	546.19	523.96	523.62	177	130		85								
46	580	558.30	536.07	536.07	177	130		86								
47	592	570.42	548.19	547.88	177	130		87								
48	604	582.54	560.31	560.31	177	130		88								
49	616	594.66	572.43	572.13	177	130		90								

**Double Sprocket #RS140 ( 1 3/4" Pitch)**

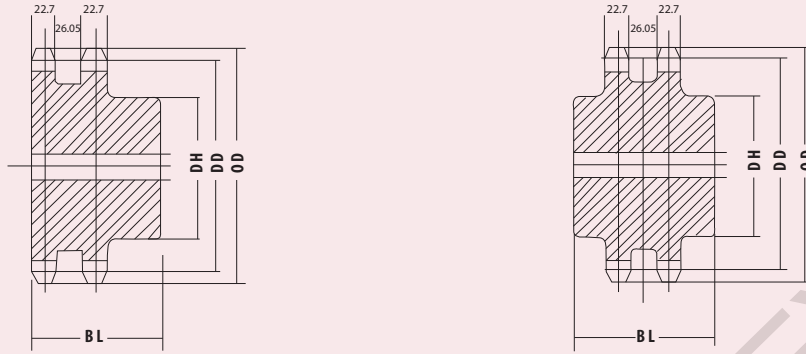

齒數 T	外徑 DO	節距徑 DP	齒底徑 DB	齒底徑 DC	輪殼		材質 MAT'	齒數 T	外徑 DO	節距徑 DP	齒底徑 DB	齒底徑 DC	輪殼		材質 MAT'
					徑 DH	長 BL							徑 DH	長 BL	
10	163	143.84	118.44	118.44	100	110	STEEL / S45C / SUS / MC NYLON	50	733	707.91	682.51	682.51	200	135	STEEL / S45C / SUS / MC NYLON
11	178	157.78	130.77	130.77	110	110		51	747	722.05	696.65	696.31	200	135	
12	193	171.74	146.34	146.34	120	110		52	762	736.19	710.79	710.79	200	135	
13	207	185.74	158.98	158.98	120	115		53	776	750.33	724.93	724.60	200	135	
14	221	199.76	174.36	174.36	130	115		54	790	764.47	739.07	739.07	200	135	
15	236	213.79	187.22	187.22	130	125		55	804	778.61	753.21	752.89	200	135	
16	250	227.84	202.44	202.44	130	130		56	818	792.75	767.35	767.35	200	135	
17	264	241.91	215.47	215.47	130	130		57	832	806.90	781.50	781.19	200	135	
18	279	255.98	230.58	230.58	130	130		58	847	821.04	795.64	795.64	200	135	
19	293	270.06	243.74	243.74	140	130		59	861	835.18	809.78	809.48	200	135	
20	307	284.15	258.75	258.75	140	130		60	875	849.32	823.92	823.92	200	135	
21	322	298.24	272.00	272.00	140	130		61							
22	336	312.34	286.94	286.94	150	130		62							
23	350	326.44	300.28	300.28	150	130		63							
24	364	340.54	315.14	315.14	150	130		64							
25	379	354.65	329.25	328.56	160	130		65							
26	393	368.77	343.37	343.37	160	130		66							
27	407	382.88	357.48	356.83	160	130		67							
28	421	397.00	371.60	371.6	160	130		68							
29	435	411.12	385.72	385.12	160	130		69							
30	450	425.24	399.84	399.84	160	130		70							
31	464	439.37	413.97	413.40	160	130		71							
32	478	453.49	428.09	428.09	160	130		72							
33	492	467.62	442.22	441.69	160	130		73							
34	506	481.75	456.35	456.35	170	130		74							
35	521	495.88	470.48	469.98	170	130		75							
36	535	510.01	484.61	484.61	170	130		76							
37	549	524.14	498.74	498.27	170	130		77							
38	563	538.27	512.87	512.87	170	130		78							
39	577	552.40	527.00	526.55	170	130		79							
40	591	566.54	541.14	541.14	190	135		80							
41	606	580.67	555.27	554.85	190	135		81							
42	620	594.81	569.41	569.41	190	135		82							
43	634	608.94	583.54	583.14	190	135		83							
44	648	623.08	597.68	597.68	190	135		84							
45	662	637.22	611.82	611.43	190	135		85							
46	676	651.35	625.95	625.95	190	135		86							
47	691	665.49	640.09	639.72	190	135		87							
48	705	679.63	654.23	654.23	190	135		88							
49	719	693.77	668.37	668.02	190	135		90							

**06B STANDARD SPROCKET**

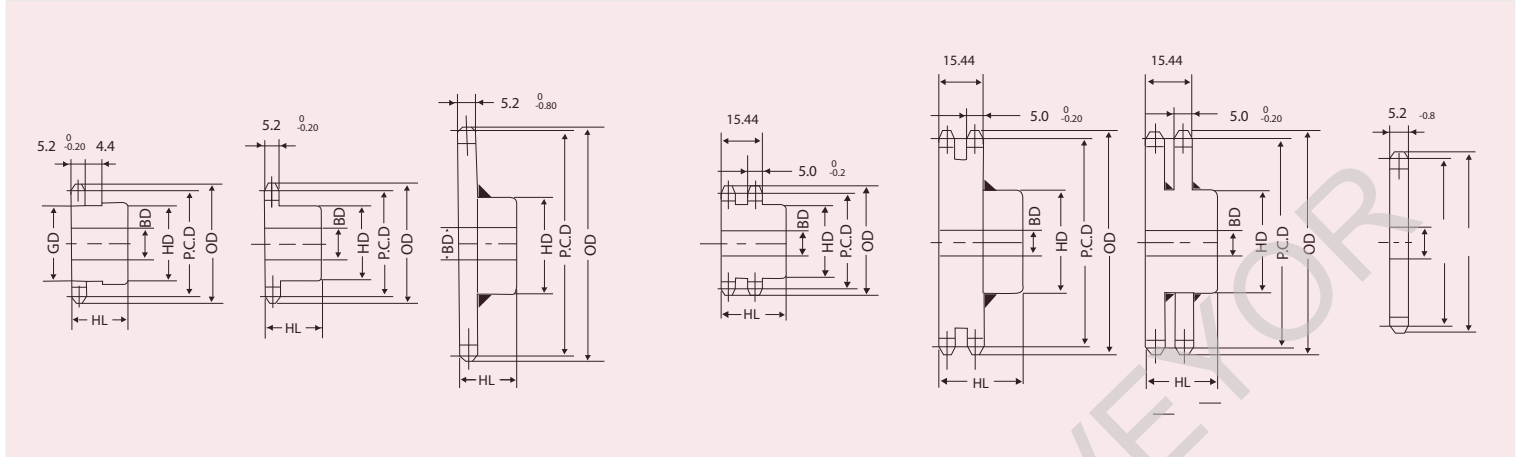

No of Teeth	Pitch Diam. P.C.D.	Outside Dia OD	SINGLE B TYPE					DOUBLE B TYPE					SINGLE A TYPE			No of Teeth		
			Bore (BD)		Hub		Approx. Weight kg	MAT	Bore (BD)		Hub		Approx. Weight kg	MAT	Bore (BD) Stock		Approx. Weight kg	MAT
			Stock	Max.	HD	HL			Stock	Max.	HD	HL						
9	27.84	32	9	11	*22	20	0.06							9	0.02		9	
10	30.84	34	9	12	*25	20	0.08							9	0.02		10	
11	33.81	38	9	14	*27	20	0.09							9	0.03		11	
12	36.80	41	10	16	*31	20	0.12							10	0.03		12	
13	39.80	44	10	18	*32	20	0.12		10	16	26	32	0.18		10	0.04		13
14	42.81	47	10	18	32	20	0.12		10	18	32	32	1.21		10	0.04		14
15	45.81	51	10	20	35	20	0.16		12	19	35	32	0.25		10	0.05		15
16	48.82	54	10	20	37	20	0.19		12	19	35	32	0.28		10	0.05		16
17	51.84	57	12	25	41	20	0.22		12	20	37	32	0.32		10	0.06		17
18	54.85	60	12	25	44	20	0.25		12	24	41	32	0.38		12	0.07		18
19	57.87	63	12	28	47	20	0.28		12	25	44	32	0.44		12	0.08		19
20	60.89	66	12	30	50	20	0.32		12	28	47	32	0.49		12	0.09		20
21	63.91	69	12	30	53	20	0.36		13	30	50	35	0.60		12	0.10		21
22	66.93	72	12	35	56	20	0.37		13	32	53	35	0.67		12	0.10		22
23	69.95	75	12	38	60	20	0.38		13	37	55	35	0.73		12	0.11		23
24	72.97	78	12	32	53	22	0.43		15	38	57	35	0.83		12	0.13		24
25	76.00	81	12	32	53	22	0.44		15	38	57	35	0.87		12	0.14		25
26	79.02	84	12	32	53	22	0.45		15	38	57	35	0.91		12	0.15		26
27	82.05	87	12	32	53	22	0.46		15	38	57	35	0.98		12	0.16		27
28	85.07	90	12	32	53	22	0.48		15	38	57	35	1.03		12	0.18		28
29	88.1	93	12	32	53	22	0.49		15	38	57	35	1.07		12	0.19		29
30	91.12	96	12	32	53	22	0.51		15	38	57	35	1.17		12	0.20		30
31	94.15	99	12	32	53	22	0.54		15	38	57	35	1.33		12	0.22		31
32	97.18	102	12	32	53	22	0.57		15	38	57	35	1.38		12	0.23		32
33	100.20	105	12	32	53	22	0.61		15	38	57	35	1.55		12	0.25		33
34	103.23	109	12	32	53	22	0.61		15	38	57	35	1.55		12	0.26		34
35	106.26	112	12	32	53	22	0.61		15	38	57	35	1.55		12	0.28		35
36	109.29	115	13	32	53	22	0.82		15	38	57	35	1.55		12	0.29		36
37	112.31	118	13	42	63	25	0.82		15	38	57	35	1.55		13	0.31		37
38	115.34	121	13	42	63	25	0.82		15	38	57	35	1.55		13	0.33		38
39	118.37	124	13	42	63	25	0.85		19	48	73	40	2.05		13	0.35		39
40	121.4	127	13	42	63	25	0.85		19	48	73	40	2.05		13	0.36		40
41	124.43	130	16	42	63	25	0.91		19	48	73	40	2.18		13	0.38		41
42	127.46	133	16	42	63	25	0.93		19	48	73	40	2.18		13	0.40		42
43	130.48	136	16	42	63	25	0.95		19	48	73	40	2.18		16	0.43		43
44	133.52	139	16	42	63	25	0.97		19	48	73	40	2.38		16	0.45		44
45	136.55	142	16	42	63	25	1.00		19	48	73	40	2.38		16	0.47		45
48	145.64	151	16	42	63	25	1.07		19	48	73	40	2.60		16	0.49		48
50	151.70	157	16	42	63	25	1.10		19	48	73	40	2.90		16	0.55		50
54	163.81	169	16	42	63	25	1.20		19	48	73	40	3.07		16	0.60		54
55	166.85	172	16	42	63	25	1.25		19	48	73	40	3.51		16	0.67		55
60	182.00	187	16	42	63	25	1.30		19	48	73	40	4.10		16	0.71		60
65	197.15	203	18	45	68	25	1.60		19	48	73	40	4.64		18	0.80		65
70	212.30	218	18	45	68	25	1.80		19	48	73	40	4.64		18	1.00		70
75	227.46	233	18	45	68	25	1.90		19	48	73	40	4.64		18	1.20		75
80	242.61	248	18	45	68	25	2.40		19	48	73	40	4.64		18	1.30		80

## 08B STANDARD SPROCKET

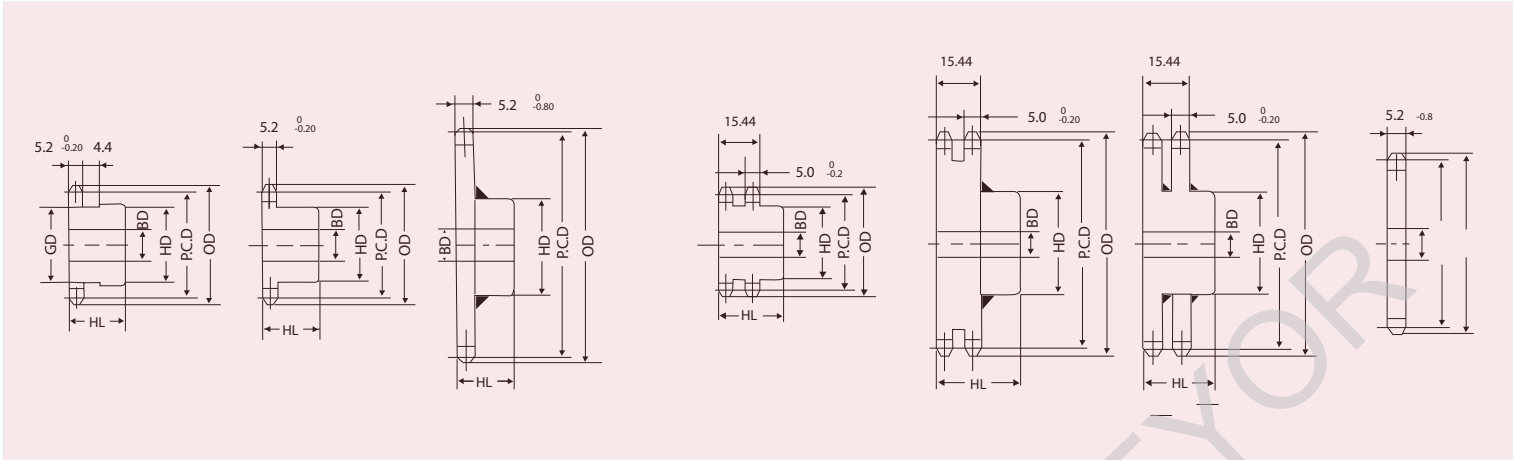

No of Teeth	Pitch Diam. P.C.D.	Outside Dia OD	SINGLE B TYPE					Approx. Weight kg	MAT	DOUBLE B TYPE					Approx. Weight kg	MAT	SINGLE A TYPE			No of Teeth
			Bore (BD)		Hub		Bore (BD)			Hub		Bore (BD)	Approx. Weight kg	MAT			Bore (BD) Stock	Approx. Weight kg	MAT	
			Stock	Max.	HD	HL				Stock	Max.									
9	37.13	42	9	16	*28	22	0.11	SAE 1040	13	16	28	35	0.28	SAE 1040	9	0.06	Mild Steel SS41	9		
10	41.10	46	10	18	*32	22	0.14		13	16	30	35	0.30		10	0.07		10		
11	15.08	51	11	20	*37	22	0.19		14	20	35	35	0.34		11	0.09		11		
12	19.07	55	11	22	*40	22	0.22		14	22	39	35	0.40		11	0.10		12		
13	53.07	59	14	20	37	22	0.23		15	25	43	35	0.47		14	0.12		13		
14	57.07	63	14	25	42	22	0.28		14	28	47	35	0.55		14	0.14		14		
15	61.08	67	14	28	46	22	0.34		14	30	50	35	0.65		14	0.16		15		
16	65.10	71	14	30	50	22	0.40		14	32	54	35	0.75		14	0.18		16		
17	69.00	76	14	32	54	22	0.46		14	38	59	35	0.85		14	0.20		17		
18	12.00	80	14	35	57	22	0.51		14	42	63	35	0.98		14	0.23		18		
19	77.16	84	14	40	62	22	0.59		14	45	67	40	1.30		14	0.26		19		
20	81.18	88	15	45	67	25	0.76		14	48	72	40	1.50		15	0.29		20		
21	85.21	92	15	48	71	25	0.85		14	51	76	40	1.60		15	0.30		21		
22	89.24	96	15	51	75	25	0.95	14	55	80	40	1.80	15	0.35	22					
23	93.27	100	15	51	77	25	1.00	18	60	88	40	2.20	15	0.38	23					
24	97.30	104	15	42	63	25	0.84	18	60	92	40	2.30	15	0.40	24					
25	101.33	108	15	42	63	25	0.88	18	66	96	40	2.50	15	0.45	25					
26	105.36	112	15	42	63	25	0.92	18	66	100	40	2.80	15	0.49	26					
27	109.40	116	15	42	63	25	0.96	23	66	100	50	3.05	15	0.50	27					
28	113.43	120	15	42	63	25	1.00	23	66	100	50	3.50	15	0.56	28					
29	117.46	124	15	42	63	25	1.05	Mild Steel SS41 ( Welding hub )	23	66	100	50	3.60	15	0.60	Mild Steel SS41	29			
30	121.50	128	15	42	63	25	1.10							15	0.63		30			
31	125.53	133	15	45	68	28	1.20							15	0.65		31			
32	129.57	137	15	45	68	28	1.30							15	0.70		32			
33	133.61	141	15	45	68	28	1.30							15	0.75		33			
34	137.64	145	15	45	68	28	1.30							18	1.10		34			
35	141.68	149	15	45	68	28	1.40							18	1.15		35			
36	145.72	153	17	45	68	28	1.50							18	1.20		36			
37	149.75	157	17	45	68	28	1.55							18	1.25		37			
38	153.79	161	17	45	68	28	1.60							18	1.30		38			
39	157.83	165	17	45	68	28	1.60	Mild Steel SS41 ( Welding hub )	23	66	100	50	4.00	18	1.10	39				
40	161.87	169	17	45	68	28	1.70							18	1.15	40				
41	165.91	173	18	48	73	32	2.00							18	1.20	41				
42	169.95	177	18	48	73	32	2.05							18	1.25	42				
43	173.98	181	18	48	73	32	2.10							18	1.30	43				
44	178.02	185	18	48	73	32	2.00							18	1.35	44				
45	182.06	189	18	48	73	32	2.25	18	1.40	45										
48	194.18	201	18	48	73	32	2.45	18	1.63	48										
50	202.26	209	18	48	73	32	2.60	18	1.80	50										
54	218.42	226	18	48	73	32	2.90	18	2.00	54										
60	242.66	250	18	48	73	32	3.40	18	2.60	60										
65	262.87	270	20	55	83	32	4.10	20	3.00	65										
70	283.07	290	20	55	83	32	4.57	20	3.50	70										
72	291.16	299	20	55	83	32	4.80	20	3.70	72										
75	303.28	311	20	55	83	32	5.10	20	4.00	75										
80	323.49	331	20	60	88	35	5.90	Mild Steel SS41 ( Welding hub )	20	60	88	35	7.40	20	4.60	80				
84	339.65	347	20	60	88	35	6.40							20	5.10	84				
85	343.69	351	20	60	88	35	6.50							20	5.20	85				
90	363.90	371	20	60	88	35	7.15							20	5.80	90				
92	371.99	379	20	60	88	35	7.40							20	6.10	92				
95	384.11	392	20	60	88	35	7.80							20	6.50	95				
96	388.15	396	20	60	88	35	8.00							20	6.60	96				

**10B STANDARD SPROCKET**

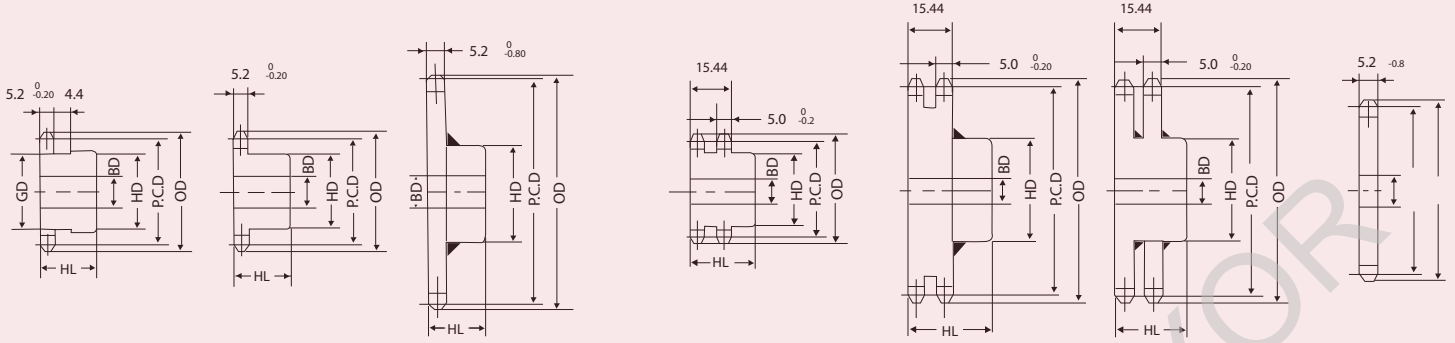

No of Teeth	Pitch Diam. P.C.D.	Out-side Dia OD	SINGLE B TYPE						DOUBLE B TYPE						SINGLE A TYPE			No of Teeth
			Bore (BD)		Hub		Approx. Weight kg	MAT	Bore (BD)		Hub		Approx. Weight kg	MAT	Bore (BD) Stock	Approx. Weight kg	MAT	
			Stock	Max.	HD	HL			Stock	Max.	HD	HL						
9	46.41	53	12	18	*34	25	0.20							12	0.11		9	
10	51.38	58	15	22	*40	25	0.27							15	0.14		10	
11	56.35	64	15	28	*46	25	0.33							15	0.17		11	
12	61.34	69	15	32	*51	25	0.41							15	0.20		12	
13	66.34	74	15	32	*51	25	0.46							15	0.23		13	
14	71.34	79	15	32	52	25	0.52		14	32	54	40	0.90	15	0.27		14	
15	76.35	84	15	35	57	25	0.62		14	38	59	40	1.10	15	0.30		15	
16	81.37	89	15	40	62	25	0.72		14	42	64	45	1.40	15	0.35		16	
17	86.39	94	15	45	67	25	0.83		14	45	68	45	1.60	15	0.40		17	
18	91.42	100	15	48	72	28	1.00		14	48	74	45	1.80	15	0.45		18	
19	96.45	105	15	48	73	28	1.10		14	55	79	45	2.11	15	0.48		19	
20	101.48	110	15	48	73	28	1.20		18	57	84	45	2.30	15	0.50		20	
21	106.51	115	15	48	73	28	1.20		18	60	89	45	2.60	15	0.60		21	
22	111.50	120	17	48	73	28	1.30		18	63	94	50	3.00	17	0.66		22	
23	116.58	125	17	48	73	28	1.30		18	66	99	50	3.50	17	0.72		23	
24	121.62	130	17	48	73	28	1.40		18	70	105	50	3.80	17	0.78		24	
25	126.66	135	17	48	73	28	1.50		18	70	105	50	4.20	17	0.85		25	
26	131.70	140	17	48	73	28	1.50		18	70	105	50	4.50	17	0.90		26	
27	136.74	145	17	48	73	28	1.50		18	70	105	50	4.80	17	1.00		27	
28	141.79	150	17	48	73	28	1.60		18	75	110	50	4.10	17	1.05		28	
29	146.83	155	17	48	73	28	1.70							17	1.12		29	
30	151.87	161	17	48	73	28	1.80		18	80	120	50	4.80	17	1.20		30	
31	156.92	166	17	48	73	28	1.85							17	1.30		31	
32	161.96	171	17	48	73	28	1.90		23	80	120	50	6.00	17	1.35		32	
33	167.01	176	17	48	73	28	2.00							17	1.45		33	
34	172.05	181	17	48	73	28	2.10							17	1.55		34	
35	177.10	186	17	48	73	28	2.20		23	80	117	50	7.00	17	1.65		35	
36	182.14	191	20	55	83	35	2.85		23	80	117	50	7.55	20	1.75		36	
37	187.19	196	20	55	83	35	2.95							20	1.85		37	
38	192.24	201	20	55	83	35	3.05		23	80	117	50	8.00	20	1.95		38	
39	197.29	206	20	55	83	35	3.15							20	2.05		39	
40	202.33	211	20	55	83	35	3.25		23	80	117	56	9.00	20	2.15		40	
41	207.38	216	20	55	83	35	3.40							20	2.25		41	
42	212.43	221	20	55	83	35	3.50		23	66	98	56	7.00	20	2.40		42	
43	217.48	226	20	55	83	35	3.60							20	2.50		43	
44	222.53	231	20	55	83	35	3.70							20	2.60		44	
45	227.58	237	20	55	83	35	3.85		23	66	98	56	7.30	20	2.70		45	
48	242.73	252	20	55	83	35	4.20		23	66	98	56	8.00	20	3.10		48	
50	252.83	262	20	55	83	35	4.50		23	66	98	56	9.00	20	3.40		50	
54	273.02	282	20	55	83	35	3.10		23	66	98	63	9.90	20	3.95		54	
60	303.33	312	20	55	83	35	6.00		23	66	98	63	11.70	20	4.90		60	
65	328.58	338	23	63	98	40	7.40		23	66	98	63	11.30	23	5.75		65	
70	353.84	363	23	63	98	40	8.30		23	66	98	63	15.00	23	6.70		70	
72	363.94	373	23	63	98	40	8.70							23	7.05		72	
75	379.10	388	23	63	98	40	9.35							23	7.70		75	
80	404.36	414	23	65	98	45	10.50							23	8.70		80	
84	424.57	434	23	65	98	45	11.50							23	9.60		84	
85	429.62	439	23	65	98	45	12.00							23	9.95		85	
90	454.88	464	23	65	98	45	13.20							23	11.00		90	
92	464.98	474	23	65	98	45	13.70							23	11.50		92	
95	480.14	489	23	65	98	45	14.40							23	12.30		95	
96	485.19	494	23	65	98	45	14.70							23	12.50		96	



## 12B STANDARD SPROCKET

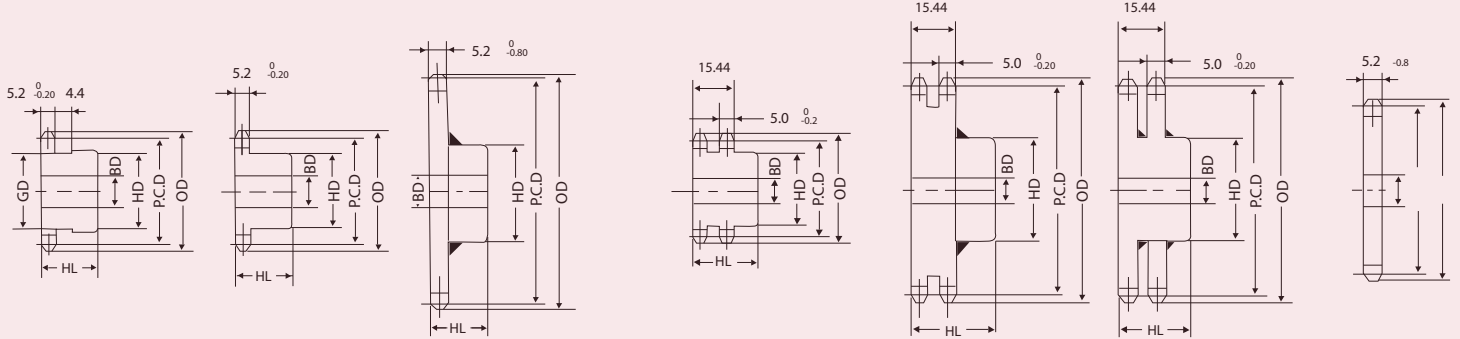

No of Teeth	Pitch Diam. P.C.D.	Out-side Dia OD	SINGLE B TYPE					DOUBLE B TYPE					SINGLE A TYPE			No of Teeth		
			Bore (BD)		Hub		Approx. Weight kg	MAT	Bore (BD)		Hub		Approx. Weight kg	MAT	Bore (BD) Stock		Approx. Weight kg	MAT
			Stock	Max.	HD	HL			Stock	Max.	HD	HL						
9	55.70	63	12	25	*43	32	0.40							12	0.22		9	
10	61.65	70	15	30	*49	32	0.49		16	20	35	50	0.90	15	0.27		10	
11	67.62	76	15	32	*51	32	0.60		16	25	44	50	1.00	15	0.30		11	
12	73.60	83	15	32	51	32	0.69		16	30	50	50	1.20	15	0.38		12	
13	79.60	89	15	35	57	32	0.81		18	38	60	50	1.40	15	0.45		13	
14	85.61	95	17	40	62	32	0.96		18	45	66	56	1.80	17	0.500		14	
15	91.62	101	17	45	68	32	1.10		18	18	72	56	2.10	17	0.60		15	
16	97.65	107	17	48	73	32	1.30		18	51	78	56	2.50	17	0.65		16	
17	103.67	113	17	48	73	32	1.40		18	55	82	56	2.60	17	0.75		17	
18	109.71	119	17	55	83	40	2.00		18	60	90	56	3.20	17	0.84		18	
19	115.74	126	17	55	83	40	2.10		18	63	94	56	3.70	17	0.93		19	
20	121.78	132	17	55	83	40	2.20		23	66	100	56	4.20	17	1.05		20	
21	127.82	138	17	55	83	40	2.30		23	66	100	56	4.40	17	1.15		21	
22	133.86	144	17	55	83	40	2.50		23	66	100	56	4.90	17	1.25		22	
23	139.90	150	17	55	83	40	2.50		23	66	100	56	4.70	17	1.40		23	
24	145.95	156	17	55	83	40	2.60		23	89	120	56	6.00	17	1.50		24	
25	151.99	162	17	55	83	40	2.70		23	89	120	56	6.40	17	1.62		25	
26	158.04	168	17	55	83	40	2.90		23	89	120	56	6.80	17	1.78		26	
27	164.09	174	21	55	83	40	3.00		23	89	120	56	7.30	21	1.90		27	
28	170.14	180	21	55	83	40	3.10		23	89	120	56	7.80	21	2.05		28	
29	176.20	187	21	55	83	40	3.30		28	89	130	56	9.00	21	2.20		29	
30	182.25	193	21	55	83	40	3.40		28	89	127	56	9.50	21	2.35		30	
31	188.30	199	21	55	83	40	3.64		28	89	127	56	9.50	21	2.50		31	
32	194.35	205	21	55	83	40	3.80		28	89	127	56	9.50	21	2.68		32	
33	200.41	211	21	55	83	40	4.00		28	89	127	56	9.50	21	2.85		33	
34	206.46	217	21	55	83	40	4.15		28	89	127	56	11.00	21	3.02		34	
35	212.52	223	21	55	83	40	4.33		28	66	98	56	8.50	21	3.00		35	
36	218.57	229	21	55	83	40	4.52		28	66	98	56	8.50	21	3.40		36	
37	224.63	235	21	55	83	40	4.70		28	66	98	56	9.00	21	3.60		37	
38	230.69	241	21	55	83	40	4.90		28	66	98	56	9.00	21	3.80		38	
39	236.74	247	21	55	83	40	5.10		28	66	98	56	9.70	21	4.00		39	
40	242.80	253	21	55	83	40	5.30		28	66	98	56	9.70	21	4.20		40	
41	248.86	260	23	63	93	45	6.00		28	75	107	56	11.00	23	4.45		41	
42	254.92	266	23	63	93	45	6.40		28	75	107	56	11.00	23	4.63		42	
43	260.98	272	23	63	93	45	6.60		28	75	107	56	11.00	23	4.85		43	
44	267.03	278	23	63	93	45	6.88		28	75	107	71	12.80	23	5.10		44	
45	273.09	284	23	63	93	45	7.10		28	75	107	71	14.00	23	5.30		45	
48	291.27	302	23	63	93	45	7.85		28	75	107	71	16.00	23	6.10		48	
50	303.39	314	23	63	93	45	8.40		28	75	107	71	18.00	23	6.60		50	
54	327.63	338	23	63	93	45	9.50		28	75	107	71	18.00	23	7.70		54	
60	363.99	375	23	63	93	45	11.30		28	75	107	71	21.50	23	9.50		60	
65	394.30	405	26	70	107	45	13.50		28	75	107	71	24.00	26	11.20		65	
70	424.61	436	26	70	107	45	15.30		28	75	107	71	30.00	26	13.00		70	
72	436.73	448	26	70	107	45	16.00		28	75	107	71	30.00	26	13.70		72	
75	454.92	466	26	70	107	45	17.20		28	75	107	71	30.00	26	14.90		75	
80	485.23	496	30	80	117	50	20.00							30	16.90		80	
84	509.48	521	30	80	117	50	21.90							30	18.70		84	
85	515.54	527	30	80	117	50	22.30							30	19.10		85	
90	545.85	557	30	80	117	50	24.60							30	21.40		90	
92	557.98	569	30	80	117	50	25.60							30	22.40		92	
95	576.17	587	30	80	117	50	27.10							30	23.90		95	
96	582.23	593	30	80	117	50	26.70							30	24.40		96	

## 16B STANDARD SPROCKET

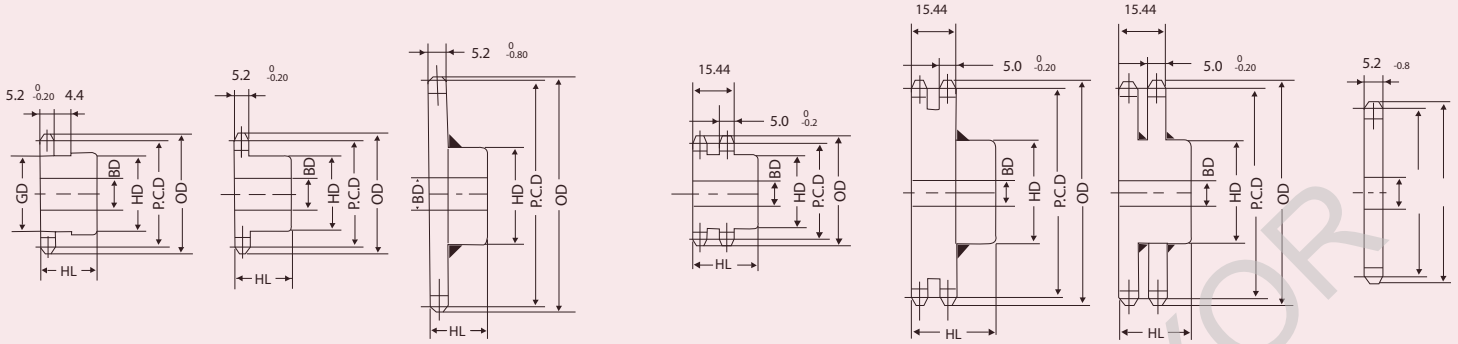

No of Teeth	Pitch Diam. P.C.D.	Out-side Dia OD	SINGLE B TYPE					DOUBLE B TYPE					SINGLE A TYPE			No of Teeth		
			Bore (BD)		Hub		Approx. Weight kg	MAT	Bore (BD)		Hub		Approx. Weight kg	MAT	Bore (BD) Stock		Approx. Weight kg	MAT
			Stock	Max.	HD	HL			Stock	Max.	HD	HL						
9	74.27	85	17	35	*58	40	0.87							17	0.49		9	
10	82.19	93	17	32	52	40	0.97		21	35	58	63	2.00	17	0.60		10	
11	90.15	102	17	38	60	40	1.20		21	38	60	63	2.50	17	0.73		11	
12	98.14	110	21	45	67	40	1.50		23	46	69	63	2.70	21	0.85		12	
13	106.14	118	21	51	77	40	1.90		23	55	80	63	3.40	21	1.00		13	
14	114.15	127	21	51	77	40	2.00		23	60	88	63	3.90	21	1.16		14	
15	122.17	135	21	63	93	40	2.60		23	63	95	63	4.40	21	1.30		15	
16	130.20	143	21	63	93	40	2.80		23	66	100	71	5.40	21	1.50		16	
17	138.23	151	21	63	93	40	3.00		23	66	100	71	6.00	21	1.70		17	
18	146.27	159	21	63	93	40	3.20		23	80	120	71	7.50	21	1.90		18	
19	154.32	167	22	63	93	40	3.40		23	80	120	71	8.00	22	2.10		19	
20	162.37	176	22	63	93	40	3.60		23	80	130	71	9.00	22	2.35		20	
21	170.42	184	22	63	93	40	3.80		23	80	130	71	9.50	22	2.57		21	
22	178.48	192	26	75	107	45	5.00		33	80	117	71	8.80	26	2.82		22	
23	186.54	200	26	75	107	45	5.23		33	80	117	71	9.30	26	3.10		23	
24	194.60	208	26	75	107	45	5.50		33	80	117	80	10.50	26	3.35		24	
25	202.66	216	26	75	107	45	5.80		33	80	117	80	11.10	26	3.65		25	
26	210.72	224	26	75	107	45	6.10		33	80	117	80	11.70	26	3.95		26	
27	218.79	233	26	75	107	45	6.40		33	80	117	80	12.50	26	4.25		27	
28	226.86	241	26	75	107	45	6.75		33	80	117	80	13.50	26	4.60		28	
29	234.93	249	26	75	107	45	7.10							26	4.93		29	
30	243.00	257	26	75	107	45	7.40		33	80	117	80	14.20	26	5.30		30	
31	251.07	265	26	75	107	45	7.80							26	5.63		31	
32	259.14	273	26	75	107	45	8.15		33	80	117	80	16.50	26	6.00		32	
33	267.21	281	26	75	107	45	8.50							26	6.40		33	
34	275.29	289	26	75	107	45	8.90							26	6.80		34	
35	283.36	297	26	75	107	45	9.30		33	80	117	80	17.90	26	7.20		35	
36	291.43	306	30	80	117	50	10.60		33	80	117	80	19.00	30	7.60		36	
37	299.51	314	30	80	117	50	11.00							30	8.00		37	
38	307.58	322	30	80	117	50	11.40		38	89	127	80	21.00	30	8.50		38	
39	315.66	330	30	80	117	50	11.90							30	8.90		39	
40	323.74	338	30	80	117	50	12.40		38	89	127	90	23.70	30	9.40		40	
41	331.81	346	30	80	117	50	12.80							30	9.90		41	
42	339.89	354	30	80	117	50	13.30		38	89	127	90	26.00	30	10.30		42	
43	347.97	362	30	80	177	50	13.80							30	10.80		43	
44	356.04	370	30	80	117	50	14.30							30	11.40		44	
45	364.12	378	30	80	117	50	14.90		38	89	127	90	28.40	30	11.90		45	
48	388.36	403	30	80	117	50	15.80		38	89	127	90	32.00	30	13.50		48	
50	404.52	419	30	80	117	50	17.65		38	89	127	90	34.00	30	14.70		50	
54	436.84	451	30	80	177	50	20.00		38	89	127	90	38.50	30	17.10		54	
60	485.33	500	30	80	117	50	23.10							30	21.10		60	
65	525.73	540	38	85	127	63	28.80		38	89	127	90	52.00	38	24.80		65	
70	566.15	581	38	85	127	63	32.10		38	89	127	90	65.00	38	28.80		70	
72	582.31	597	38	85	127	63	34.50							38	30.50		72	
75	606.56	621	38	85	127	63	36.20							38	33.10		75	
80	646.97	662	38	90	137	63	42.90							38	37.60		80	
84	679.31	694	38	90	137	71	46.70							38	41.50		84	
85	687.39	702	38	90	137	71	47.70							38	42.50		85	
90	727.80	743	38	90	137	71	52.90							38	47.60		90	
92	743.97	759	38	90	137	71	55.00							38	49.80		92	
95	768.22	783	38	90	137	71	58.30							38	53.10		95	
96	776.31	791	38	90	137	71	59.40							38	54.20		96	

**20B STANDARD SPROCKET**

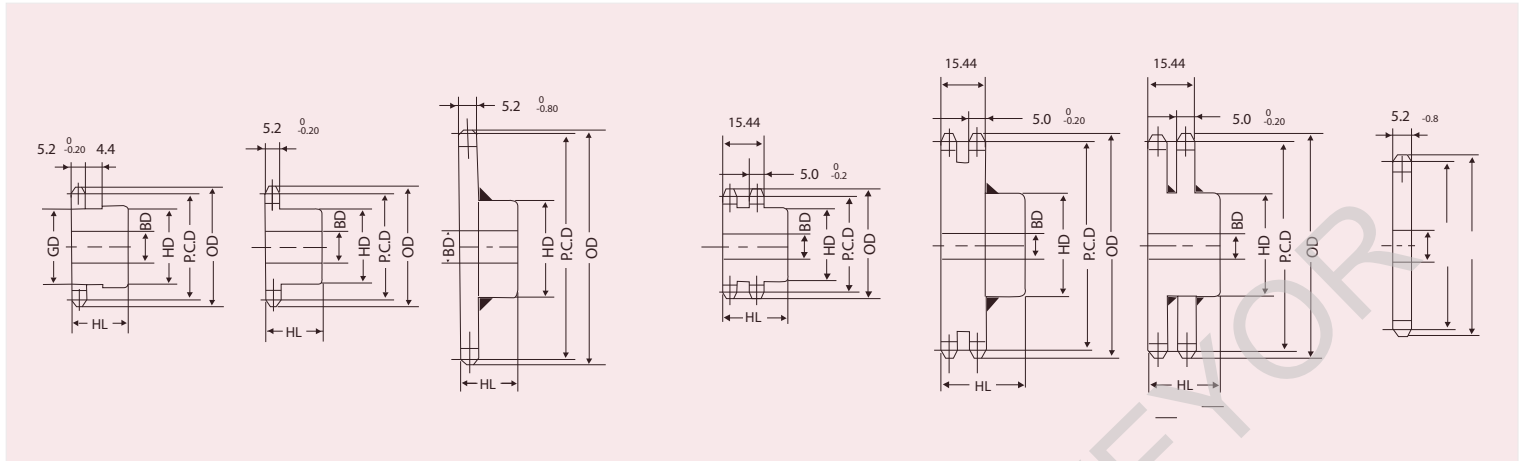

No of Teeth	Pitch Diam. P.C.D.	Out-side Dia OD	SINGLE B TYPE					DOUBLE B TYPE					SINGLE A TYPE			No of Teeth			
			Bore (BD)		Hub		Approx. Weight kg	MAT	Bore (BD)		Hub		Approx. Weight kg	MAT	Bore (BD) Stock		Approx. Weight kg	MAT	
			Stock	Max.	HD	HL			Stock	Max.	HD	HL							
9	92.84	106	21	40	62	50	1.60							21	0.90		9		
10	102.74	117	22	45	65	50	1.90	22	46	70	80	3.50	SAE 1040	22	1.10		10		
11	112.70	127	22	51	75	50	2.30	22	55	80	80	4.20		22	1.33		11		
12	122.67	138	22	57	86	50	2.90	28	60	90	80	5.00		22	1.60		12		
13	132.67	148	22	63	94	50	3.10	28	66	100	80	6.00		22	1.90		13		
14	142.68	158	22	66	98	50	3.60	28	75	110	80	7.00		SAE1040 (Welding hub)	22	2.15		14	
15	152.71	168	22	66	98	50	4.20	28	80	120	80	7.10			22	2.50		15	
16	162.74	178	22	66	98	50	4.60	28	89	130	80	7.70			22	2.83		16	
17	172.79	189	22	75	107	50	5.30	28	89	130	80	8.90			22	3.20		17	
18	182.84	199	22	75	107	50	5.70	28	89	130	80	9.60			22	3.60		18	
19	192.90	209	26	75	107	50	6.10	28	89	130	90	12.80			Mild Steel SS41 (Welding hub)	26	4.00		19
20	202.96	220	26	75	107	50	6.50	28	89	130	90	13.50		26		4.40		20	
21	213.03	230	26	75	107	50	7.00	28	89	130	90	14.30		26		4.90		21	
22	223.10	240	30	80	117	56	7.90	28	89	127	90	15.50		30		5.35		22	
23	233.17	250	30	80	117	56	8.50	28	89	127	90	16.60	30	5.80			23		
24	243.25	260	30	80	117	56	8.80	38	95	137	90	17.80	Mild Steel SS41 (Welding hub)	30	6.40		24		
25	253.32	270	30	80	117	56	9.30	38	95	137	90	18.50		30	6.90		25		
26	263.40	281	30	80	117	56	9.80	38	95	137	90	19.80		30	7.50		26		
27	273.49	291	30	80	117	56	10.30	38	95	137	90	21.00		30	8.10		27		
28	283.57	301	30	80	117	56	10.90	38	95	137	90	22.00		30	8.70		28		
29	293.66	311	30	80	117	56	11.50	Mild Steel SS41 (Welding hub)	38	95	137	90		24.00	30	9.30		29	
30	303.75	321	30	80	117	56	12.10		38	95	137	90		27.30	30	10.00		30	
31	313.83	331	35	80	117	56	13.00		Mild Steel SS41 (Welding hub)	38	95	137		90	30.00	35	10.65		31
32	323.92	341	35	80	117	56	13.40			38	95	137		90	32.90	35	11.35		32
33	334.01	352	35	80	117	56	14.50			38	95	137		90	36.50	35	12.00		33
34	344.11	362	35	80	117	56	16.10	Mild Steel SS41 (Welding hub)		38	95	137	90	40.00	35	12.80		34	
35	354.20	372	35	89	127	63	16.60			38	95	137	90	45.70	35	13.50		35	
36	364.29	382	35	89	127	63	17.50		38	95	137	90	49.00	35	14.40		36		
37	374.38	392	35	89	127	63	18.00		38	95	137	90	53.30	35	15.10		37		
38	384.48	402	35	89	127	63	18.90		38	95	137	90	63.00	35	16.00		38		
39	394.57	412	35	89	127	63	20.00	Mild Steel SS41 (Welding hub)	38	103	147	100	68.30	35	16.80		39		
40	404.67	422	35	89	127	63	20.40		38	103	147	100	77.00	35	17.70		40		
41	414.77	433	35	89	127	63	21.50		38	103	147	100	85.00	35	18.60		41		
42	424.86	443	35	89	127	63	22.60		38	103	147	100	93.00	35	19.50		42		
43	434.96	453	35	89	127	63	23.50		38	103	147	100	101.00	35	20.50		43		
44	445.06	463	35	89	127	63	24.00	Mild Steel SS41 (Welding hub)	38	103	147	100	109.00	38	21.45		44		
45	455.16	473	35	89	127	63	24.70		38	103	147	100	117.00	38	22.40		45		
48	485.45	503	35	89	127	63	27.50		38	103	147	100	125.00	38	25.50		48		
50	505.65	524	38	89	127	63	30.00		38	103	147	100	133.00	38	27.70		50		
54	546.05	564	38	103	147	80	37.40		38	103	147	100	141.00	38	32.30		54		
60	606.66	625	38	103	147	80	44.30	Mild Steel SS41 (Welding hub)	38	103	*147	125	149.00	38	39.90		60		
65	657.17	675	38	103	147	80	53.00		38	103	147	100	157.00	38	46.80		65		
70	707.68	726	38	103	*147	100	44.70		38	103	147	100	165.00	38	54.30		70		
72	727.89	746	38	103	*147	100	46.00		38	103	147	100	173.00	38	57.40		72		
75	758.20	777	38	103	*147	100	47.00		38	103	147	100	181.00	38	62.30		75		

